



CATALOG#: _____
PROJECT: _____
TYPE: _____

Series WLIN

Direct/Indirect Wall Mount

Specification grade, low profile direct/indirect wall mount with up and forward throw optics, the WLIN is a sleek wall mount companion to the pendant mount indirect LIN. This wall mount is ideal for brightening perimeters of offices or spectacular wall lighting systems for corridors.

CONSTRUCTION

Housing is die-formed and embossed code 22 gauge steel with die cast aluminum end caps. Standard finish is powder coat white. Custom colors available. An enhanced white aluminum reflector is included.

MOUNTING

Wall bracket mount

TYPICAL OPTIONS & ACCESSORIES

Options of drivers and custom colors. Companion wall mount fixture to the LIN Series Direct/Indirect pendant.



DIMENSIONS

5.03"W x 48.0"L x 2.68"Dp
5.03"W x 96.0"L x 2.68"Dp Tandems

FEATURES & BENEFITS

- Continuous row mounting
- Post painted powder coat finish
- White, standard. Custom colors available.
- Suitable for dry and damp locations
- 50,000 hrs of L70 LED life
- CRI >80
- 0-10 Volts dimmable 120-277V
- Power factor 0.99
- 5 year warranty



DRAWINGS & IMAGES

48L

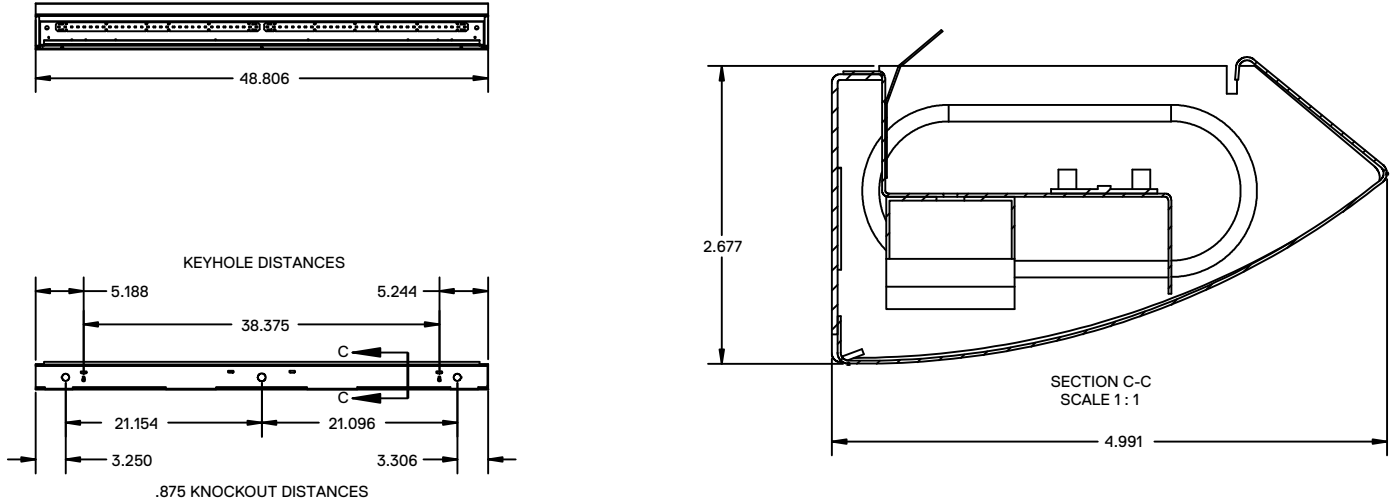

96L

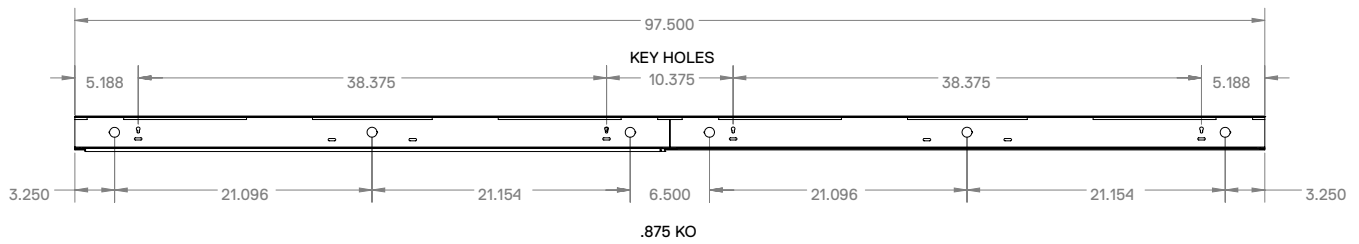

Mounting Option



Mounted on Ceiling



Mounted on Wall

* Companion to the LIN series pendant mount indirect



CATALOG#: _____
 PROJECT: _____
 TYPE: _____

Series WLIN

Direct/Indirect Wall Mount

ORDER INFORMATION

SERIES	BODY STYLE	SIZE	WATTAGE & LUMENS	DRIVER	CCT	FINISH
WLIN	PF Perforated	48L 48"	UJ24WD12W Uplight 24 Watts Downlight 12 Watts 3600 Lumens	DMV 120-277VAC 0-10V Dimming	30K 3000K 35K 3500K 40K 4000K 50K 5000K	WH White (standard) **Custom color available
	MW White Lens		UZ36WD18W Uplight 36 Watts Downlight 18 Watts 5400 Lumens			
	LV Louver	96L 96"	UJ48WD24W Uplight 48 Watts Downlight 24 Watts 7200 Lumens	G120 ELV/TRIAC Dimming at 120V only		
			UZ72WD36W Uplight 72 Watts Downlight 36 Watts 10800 Lumens			

CONFIGURATION	
Blank	Standard fixture includes end caps
-J	Joiner-no end caps are furnished joiner sections
-B	Beginner Run
-E	Ender Run

*Programmable LED drivers allow custom configured wattages and corresponding lumens.

NOTE: Values shown are typical or recorded under standardized conditions at 25°C. Actual performance may vary based environment or application. Specifications are subject to change without notice. We reserve the right to change design, materials, LED's and finish in any way that will not alter installed appearance or reduce function and performance.