

# Series 44R

## LED Recessed Linear Fixture for T-Grid Ceiling

A linear 4 x 4 fixture for distinctive architectural lighting plans. Ideal for corridors, lobbies, and office areas, 4 x 4 Series fixtures can be installed individually or in a continuous run. Specially designed for direct light only with snap in lens to hide the LED arrays. Ideal for corridors, lobbies, and office areas, etc.

### CONSTRUCTION

Die-formed and welded 22-gauge cold rolled steel. Knockouts on ends allow continuous wireway mounting. Housing is specially designed for smooth and uniform ambient lighting for all commercial and industrial buildings with recessed configurations.

### DIFFUSERS

Fixture accepts various lenses or louvers. 4' and 8' units have a steel mullion to join two individual diffusers.

### TYPICAL OPTIONS & ACCESSORIES

Cord sets, whips, occupancy sensors. Contact factory for more details.



### DIMENSIONS

- 2ft. - 24"L x 4"W x 4"H
- 4ft. - 48"L x 4"W x 4"H
- 6ft. - 72"L x 4"W x 4"H
- 8ft. - 96"L x 4"W x 4"H

### FEATURES & BENEFITS

- Can be recessed mounted to the drywall ceiling
- Attractive source of direct lighting for use in offices, hallways, conference rooms and medical facilities
- External emergency battery backup is available
- Available in custom finish. Consult factory for details
- Driver conforms to FCC Title 47 Part 15 Class A
- Suitable for dry or damp location
- CRI >80 standard
- L70: >50,000 Hours
- Dimming: 0-10V 120-277V standard, 120V ELV/TRIAC optional
- Power factor >0.99
- 100 lm/w
- 5 year warranty



CATALOG# :

PROJECT :

TYPE :

## Series 44R

LED Recessed Linear  
4" X 4" for T Bar Ceiling

### ORDER INFORMATION

Factory at your fingertips. Fill in the blanks to create your part number or create a custom configuration.

SERIES	LENS MATERIAL	LENGTH	GEAR	WATTAGE & LUMENS <sup>1</sup>		DRIVER	
<b>44R</b> Recess For 1" T-Bar Grid Ceiling  <b>44RWW</b> Recess For 1" T-Bar Grid Ceiling w/Wall Wash Reflector	SF Snap-in frosted acrylic lens (85% transmission) Special for LEDs; only available for uplight and downlight	24L 23.45"	K	12W	12 Watts, 1400 Lumens	DMV	120-277VAC 0-10V Dimming
				24W	24 Watts, 2900 Lumens	G120	ELV/TRIAC Dimming at 120V only
		48L 48"		24W	24 Watts, 2900 Lumens	D1MV	120-277VAC 0-10V Dimming (dim to 1%)
				48W	48 Watts, 5800 Lumens	SRMV	120-277VAC Phillips Sensor-Ready
	MW Matte white lens (Only available for downlight)	72L 72"		36W	36 Watts, 4300 Lumens	DALMV	120-277VAC DALI Dimming
				72W	72 Watts, 8600 Lumens		
		96L 96"		48W	48 Watts, 5800 Lumens		
				96W	96 Watts, 11500 Lumens		

FINISH <sup>2</sup>		CCT/CRI <sup>3</sup>		CONFIGURATION		EMERGENCY		SENSOR	
WH	White	30K	3000K 80 CRI	Blank	Individual	EM14	14W Emergency battery backup (integrated in fixtures 4' and longer)	SS	On/Off Sensor
BK	Black	35K	3500K 80 CRI	-B	Beginner Run			SV	Bi-Level Sensor
SL	Silver	40K	4000K 80 CRI	-E	Ender Run			SD	Daylight Harvesting Sensor
**	Custom Color	40K	4000K 80 CRI	-J	Joiner			SM	Microwave Sensor
		50K	5000K 80 CRI			CP	Chicago Plenum		
		930K	3000K 90 CRI						
		935K	3500K 90 CRI						
		940K	4000K 90 CRI						

Note:

<sup>1</sup> Programmable LED drivers allow custom configured wattages and corresponding lumens.

<sup>2</sup> \*\*RAL custom finishes available. Consult factory for more information or pricing requests.

<sup>3</sup> Consult factory for 90 CRI 5000K availability.

**NOTE:** Values shown are typical or recorded under standardized conditions at 25°C. Actual performance may vary based environment or application. Specifications are subject to change without notice. We reserve the right to change design, materials, LED's and finish in any way that will not alter installed appearance or reduce function and performance.

## DRAWINGS & IMAGES

### RECESSED MOUNT (G) DRAWINGS & DIMENSIONS

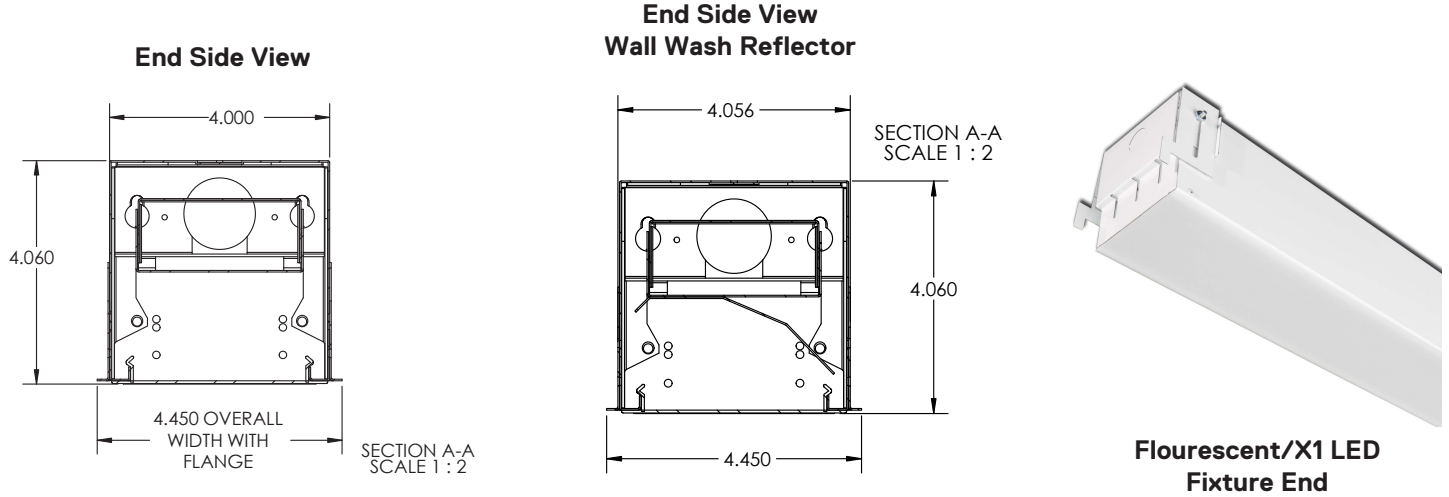

#### 4FT

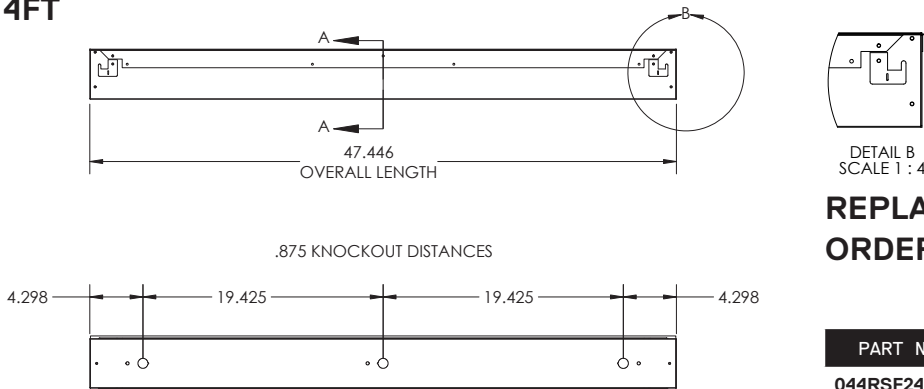

### REPLACEMENT LENS ORDERING INFORMATION

PART NO.	DESCRIPTION
044RSF24L	Replacement Snap in Frosted lens for 24"
044RSF48L	Replacement Snap in Frosted lens for 48"
044RSF72L	Replacement Snap in Frosted lens for 72"
044RSF96L	Replacement Snap in Frosted lens for 96"

#### 8 FT

