

SMC Series

Micro LED Close-To-Ceiling Fixture

Finally, a fresh, modern approach to the old fashioned close-to-ceiling surface mount lights ideal for circulation spaces, living spaces and wet locations. This Contemporary Micro LED close-to-ceiling fixture with a matte white body and a translucent white acrylic diffuser mounts simply to a standard 4 inch junction box and is less than 2 inches deep in a crisp, flat edged style that provides a sophisticated look.

These Micro-LED close-to-ceiling fixtures are particularly a good solution in wet location applications where normally a much larger and usually simple utilitarian look is used like in outdoor breezeways and showers/bathroom applications. They are also stylish substitutes for recessed downlights especially where ceiling obstructions or codes m

CONSTRUCTION

Heavy gauge metal housing is powder coated white and houses 120V LED array and 20W driver. Driver is dimmable with standard incandescent dimmers.* LED are comfortably diffused with Translucent White Opal Acrylic diffuser to provide a glare free light.



FIXTURE DIMENSIONS

SMC4L: 5.9"OD x 1.20"H

SMC6L: 7.4"OD x 1.26"H

SMC11L: 11.5"OD x 1.4"H

SMC15L: 15.5"OD x 1.4"H

SPECIFICATIONS

- Surface mount
- Many lumen package / wattage options via programmable drivers
- Multiple Kelvin temperature options (3000K, 3500K, 4000K, 5000K)
- Emergency battery backup options available
- CRI >80 (90 CRI available)
- >50,000 hrs of L70 LED life
- Rated for dry and damp locations
- 0-10 Volt dimmable 120-277V (120V ELV/TRIAC avail)
- Power factor >0.90
- 5 year warranty

CATALOG# :

PROJECT :

TYPE :

SMC Series

Micro LED CTC

Ordering Guide

ITEM NO.	DESCRIPTION
SMC4L12W900L30KWH (or BZ)	Micro LED CTC 4" (5.9" OD) White (or Bronze), 12W 876 lumens, CRI ≥80, 3000K, 120V, with 20W Dimmable Driver. Surface Mount.
SMC4L12W900L30KBN	Micro LED CTC 4" (5.9" OD) Brushed Nickel, 12W 876 lumens, CRI ≥80, 3000K, 120V, with 20W Dimmable Driver. Surface Mount.
SMC6L15W1100L30KWH (or BZ)	Micro LED CTC 6" (7.4" OD) White (or Bronze), 15W 1095 lumens, CRI ≥80, 3000K, 120V, with 20W Dimmable Driver. Surface Mount.
SMC6L15W1100L30KBN	Micro LED CTC 6" (7.4" OD) Brushed Nickel, 15W 1095 lumens, CRI ≥80, 3000K, 120V, with 20W Dimmable Driver. Surface Mount.
SMC9L26W2100L30KWH*	Micro LED CTC 9" (9.5" OD) White, 26W 2100 lumens, CRI ≥80, 3000K, 120V, with 26W Dimmable Driver. Surface Mount.

*Driver is internally integrated, external driver not available

Emergency and 277V Options

ITEM NO.	DESCRIPTION
SMC6L15W1100L30KWH-277	Surface Disc in 277V 15W, 1100L, 30K in White
SMC6L15W1100L30KWH-EM	Surface Disc with Integral Emergency Back-Up in recessed junction Box. Emergency version comes with junction box. 15Watt, 1095Lm, 6Watt EM at 400Lm, 30K in White.

0-10V Dimming

(Dims to 10% with standard dimmers)

ITEM NO.	DESCRIPTION
SMC11L8W1700LD12030KWH (or BN)	Micro LED CTC 11" (11.5" OD) White (or Brush Nickel), 28W 1700 lumens, 3000K, 120V, with 28W 0-10V Dimmable Driver. Surface Mount.
SMC15L40W2500LD12030KWH (or BN)	Micro LED CTC 15" (15.5" OD) White (or Brush Nickel), 40W 2500 lumens, 3000K, 120V, with 40W 0-10V Dimmable Driver. Surface Mount.

Recessed Accessory Kits

ITEM NO.	DESCRIPTION
SMC4RECACC	Recessed Accessory Kit to Retrofit SMC4L Series into 4" Recessed White Can Housings
SMC6RECACC	Recessed Accessory Kit to Retrofit SMC6L Series into 6" Recessed White Can Housings

*Programmable LED drivers allow custom configured wattages and corresponding lumens.

We reserve the right to change design, materials, LED's and finish in any way that will not alter installed appearance or reduce function and performance.

Mounting Detail

4 inch or 6 inch Surface Mount

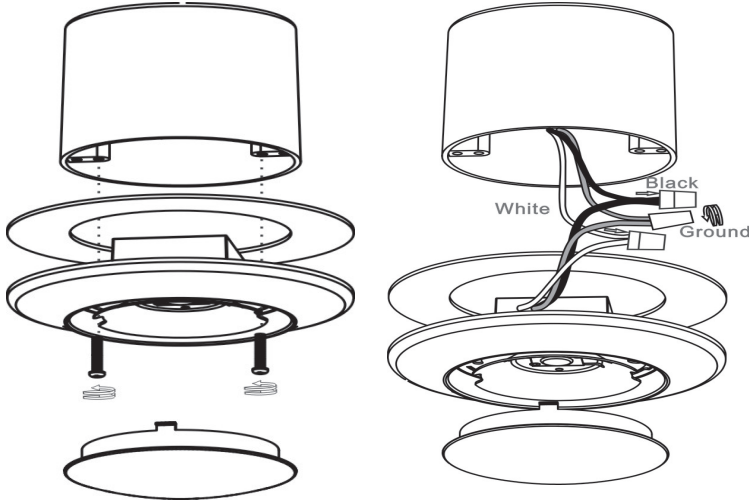

Recessed Accessory Kit

Order separately a Recessed Accessory Kit to easily adapt the SMC series to 4" and 6" white cans. Save over 75% energy from incandescent equivalent fixtures and lasts 40 times longer.



4" Accessory Kit

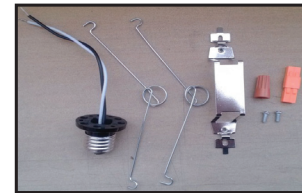

6" Accessory Kit

Mounting Detail

11 inch or 15 inch Surface Mount

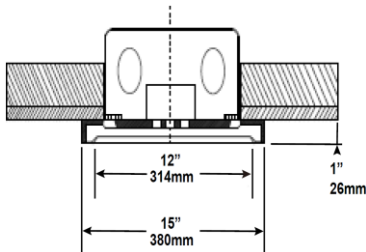
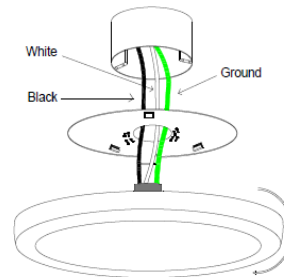
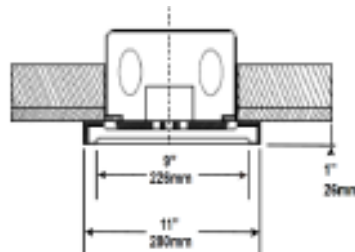
4 inch Recessed Mount (Requires Accessory Kit)

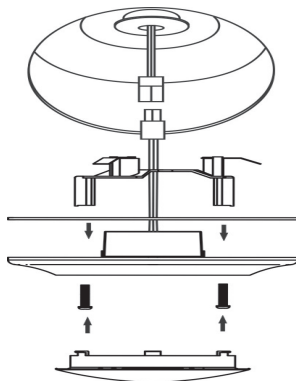

6 inch Recessed Mount (Requires Accessory Kit)

