

Series 44R

LED Recessed Linear Fixture for T-Grid Ceiling

A linear 4 x 4 fixture for distinctive architectural lighting plans. Ideal for corridors, lobbies, and office areas, 4 x 4 Series fixtures can be installed individually or in a continuous run. Specially designed for direct light only with snap in lens to hide the LED arrays. Ideal for corridors, lobbies, and office areas, etc.

CONSTRUCTION

Die-formed and welded 22-gauge cold rolled steel. Knockouts on ends allow continuous wireway mounting. Housing is specially designed for smooth and uniform ambient lighting for all commercial and industrial buildings with recessed configurations.

DIFFUSERS

Fixture accepts various lenses or louvers. 4' and 8' units have a steel mullion to join two individual diffusers.

TYPICAL OPTIONS & ACCESSORIES

Cord sets, whips, occupancy sensors. Contact factory for more details.

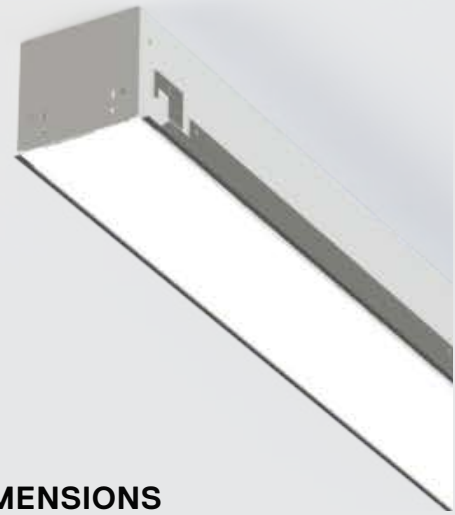

DIMENSIONS

2ft. - 24"L x 4"W x 4"H

4ft. - 48"L x 4"W x 4"H

8ft. - 96"L x 4"W x 4"H

FEATURES & BENEFITS

- Can be recessed mounted to the drywall ceiling
- Attractive source of direct lighting for use in offices, hallways, conference rooms and medical facilities
- External emergency battery backup is available
- Available in custom finish. Consult factory for details
- Driver conforms to FCC Title 47 Part 15 Class A
- Suitable for dry or damp location
- CRI >80 standard
- L70: >50,000 Hours
- Dimming: 0-10V 120-277V standard, 120V ELV/TRIAC optional
- Power factor >0.99
- 100 lm/w
- 5 year warranty



CATALOG# :

PROJECT :

TYPE :

Series 44R

LED Recessed Linear
4" X 4" for T Bar Ceiling

ORDER INFORMATION

Factory at your fingertips. Fill in the blanks to create your part number or create a custom configuration.

SERIES		LENS MATERIAL		LENGTH		GEAR	WATTAGE & LUMENS ¹		DRIVER	
44R Recess For 1" T-Bar Grid Ceiling 44RW Recess For 1" T-Bar Grid Ceiling w/Wall Wash Reflector	SF	Snap-in frosted acrylic lens (85% transmission) Special for LEDs; only available for uplight and downlight		24	24"	LR	12W	12 Watts, 1200 Lumens	DMV	120-277VAC 0-10V Dimming
							24W	24 Watts, 2400 Lumens		G120
							24W	24 Watts, 2400 Lumens	D1MV	
	MW	Matte white lens (Only available for downlight)			48W		48 Watts, 4800 Lumens	SRMV		120-277VAC Phillips Sensor-Ready
					48W		48 Watts, 4800 Lumens		DALMV	120-277VAC DALI Dimming
					96W		96 Watts, 9600 Lumens			

										OPTIONS	
FINISH ²		CCT/CRI ³		CONFIGURATION		EMERGENCY		SENSOR			
WH	White	30K	3000K 80 CRI	Blank	Individual	EM14	14W Emergency battery backup (integrated in fixtures 4' and longer)	SS	On/Off Sensor		
BK	Black		35K		3500K 80 CRI			-B	Beginner Run	SV	Bi-Level Sensor
SI	Silver	40K		4000K 80 CRI	-E	Ender Run	SD	Daylight Harvesting Sensor			
**	Custom Color		50K	4000K 80 CRI	-J	Joiner	CP	Chicago Plenum	SM	Microwave Sensor	
		930K		5000K 80 CRI							
				3000K 90 CRI							
				3500K 90 CRI							
		935K	3500K 90 CRI								
		940K	4000K 90 CRI								

Note:

1. Programmable LED drivers allow custom configured wattages and corresponding lumens.
2. RAL custom finishes available. Consult factory for more information or pricing requests.
3. Consult factory for 90 CRI 5000K availability.

* Programmable LED drivers allow custom configured wattages and corresponding lumens.

NOTE: Values shown are typical or recorded under standardized conditions at 25°C. Actual performance may vary based environment or application. Specifications are subject to change without notice. We reserve the right to change design, materials, LED's and finish in any way that will not alter installed appearance or reduce function and performance.

DRAWINGS & IMAGES

RECESSED MOUNT (G) DRAWINGS & DIMENSIONS

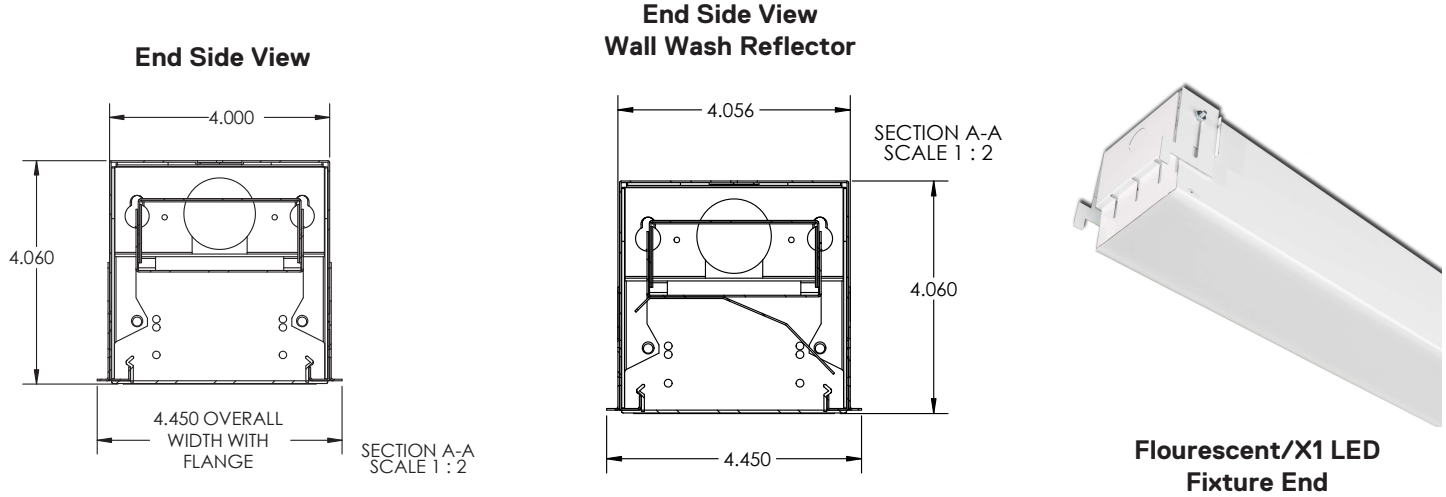

4FT

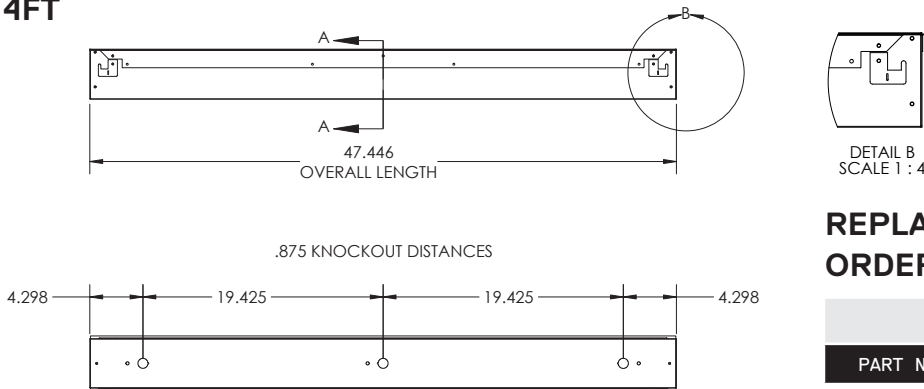

REPLACEMENT LENS ORDERING INFORMATION

PART NO.	DESCRIPTION
044RSF24L	Replacement Snap in Frosted lens for 24"
044RSF48L	Replacement Snap in Frosted lens for 48"
044RSF96L	Replacement Snap in Frosted lens for 96"

8 FT

