



CATALOG# : \_\_\_\_\_  
PROJECT : \_\_\_\_\_  
TYPE : \_\_\_\_\_



# RFSF Series

## LED Medium Body Retrofit Strip w/Lens

This high-performance retrofit strip fixture is now available with a lens. The RFSF Series offering is perfect for many applications including: retail, industrial, and back of house applications. RFSF fixtures are designed and manufactured economically, yet balances sleek aesthetics and function. This fixture is perfect for Mezzanine and low ceiling installations where a wide distribution light pattern is needed.

### CONSTRUCTION

Describe materials used for manufacturing pan and other parts. Mention material type, gauge, and color.

### MOUNTING

Surface mount, chain hung, or double stem mounted.

### TYPICAL OPTIONS AND ACCESSORIES

Whips, wireguards, and emergency battery backups available. Contact factory for more options.

### FIXTURE DIMENSIONS

2ft: 4.25W x 24.00L x 3.25H  
4ft: 4.25W x 48.00L x 3.25H  
8ft: 4.25W x 96.00L x 3.25H

### SPECIFICATIONS

- 3 standard lengths – 2ft, 4ft, 8ft
- Surface, chain, or stem mount kits adapt to most ceiling types
- Many lumen package / wattage options via programmable drivers
- Multiple Kelvin temperature options (3000K, 3500K, 4000K, 5000K)
- Emergency battery backup options available
- CRI >80
- >50,000 hrs of L70 LED life
- 0-10 Volt dimmable 120-277V
- Power factor >0.90
- 5 year warranty



CATALOG#: \_\_\_\_\_  
 PROJECT: \_\_\_\_\_  
 TYPE: \_\_\_\_\_

# RFSF Series

LED Medium Body Retrofit Strip w/Lens

## ORDERING GUIDE

Factory at your fingertips. Fill in the blanks to create your part number or create a custom configuration.

Sample Part Number: RFSF-FR-24L-Z24W2400L-DMV-30K

SERIES	DIFFUSER		LENGTH		WATTAGE*		DRIVER		CCT/CRI			
RFSF Medium Body Retrofit Strip	FR	Frosted Lens	24L	24"L	Y12W1200L	12 Watts 1,200 Lumens	DMV	120-277VAC 0-10V Dimming	30K	3000K 80 CRI		
					Y24W2400L	24 Watts 2,400 Lumens			35K	3500K 80 CRI		
					48L	48"L			Y24W2600L	24 Watts 2,600 Lumens	40K	4000K 80 CRI
									Y48W5400L	48 Watts 5,400 Lumens		
									Y57W6200L	57 Watts 6,200 Lumens		
					96L	96"L			Y62W6600L	62 Watts 6,120 Lumens	50K	5000K 80 CRI
			Y114W12400L	114 Watts 9315 Lumens								

OPTIONS	
WP	6 ft. 3 wire 18 gauge whip
WP10	6 ft. 4 wire 18 gauge whip
EM	14W Emergency Battery Backup
PI1	3 Wire Harness
PI3	5 Wire Harness

\*Programmable LED drivers allow custom configured wattages and corresponding lumens.

**NOTE:** Values shown are typical or recorded under standardized conditions at 25°C. Actual performance may vary based on environment or application. Specifications are subject to change without notice. We reserve the right to change design, materials, LED's and finish in any way that will not alter installed appearance or reduce function and performance.

## PRODUCT DIMENSIONS

### 2FT

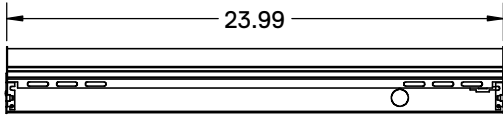

#### .875 KNOCKOUT DISTANCES

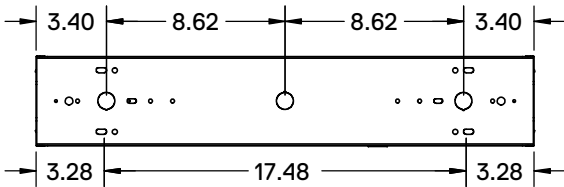

#### HANGING DIMENSIONS

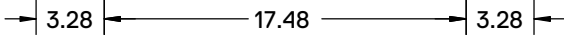

### 4FT

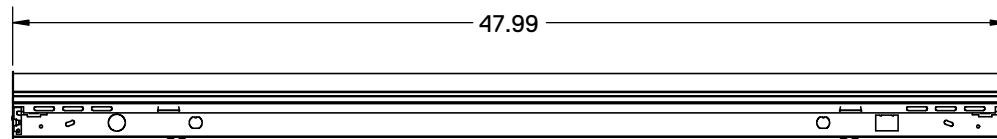

#### .875 KNOCKOUT DISTANCES

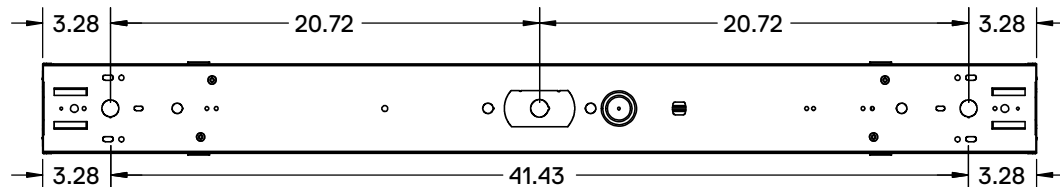

#### HANGING DIMENSIONS

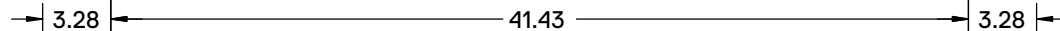

### 8FT

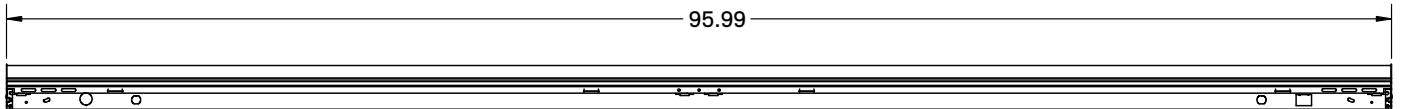

#### .875 KNOCKOUT DISTANCES

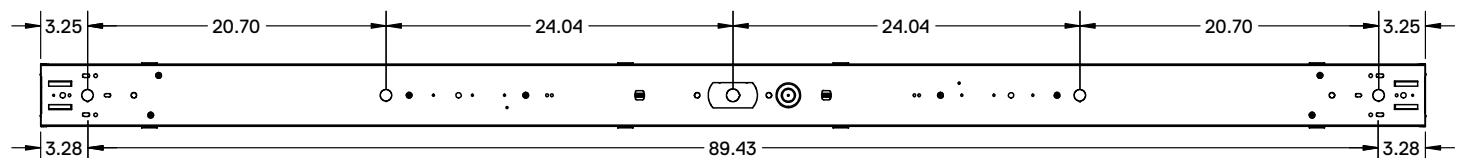

#### HANGING DIMENSIONS

