

Series RKITB

Retrofit Kit for Recessed Linear

Designed to convert 4' or 8' T12 or T8 recessed linear fixtures to more efficient T8, T5 or LED technology. Choose between retrofitting with simply a ballast cover or consult for other LED options. The kit utilizes socket brackets engineered to fit the fluorescent channels. The Reflector/Ballast Cover mounts to socket brackets with quarter turn fasteners for easy maintenance after retrofit is complete. (What is last sentence)

MOUNTING

The RKITB retrofit kit mounts easily, requiring only simple hand tools. The process includes removal of the existing ballast cover(s) and removal of the existing socket bracket and ballast. The new ballast cover is then attached to the existing strip channel with socket brackets and self-tapping screws. The socket bracket can fit inside channels. The ballast cover serves to cover the housing. Mount and connect sockets to socket bars. Close the ballast cover using captive quarter turns and install lamps.

REFLECTORS

Precision formed, high performance, premium mirrored specular reflector to enhance white reflector.

ELECTRICAL

Lamps are secured with rotary locking lamp sockets for ease of relamping and to reduce lamps disconnecting due to vibration or incidental contact. Suitable for damp locations. Lamp sockets accepts No. 18 gauge wire, either solid, solder dipped or twisted tinned or fused wire.

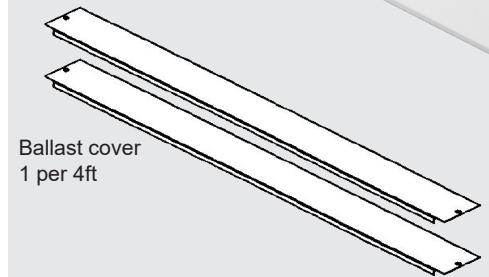
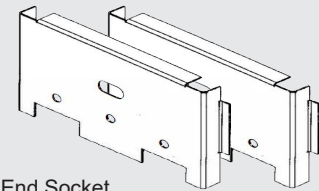
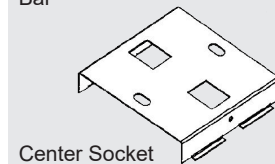
Ballast cover
1 per 4ftEnd Socket
BarCenter Socket
Bar

DIMENSIONS

4 ft

8 ft

FEATURES & BENEFITS

- Update popular fluorescent linear recessed to LED T8 lamps providing energy savings, improved lighting and long life.
- Retrofit kit installs in minutes with only three components
- 1 or 2 lamp positions
- UL Listed when supplied with T8 LED lamps



DRAWINGS & IMAGES

Ballast Cover

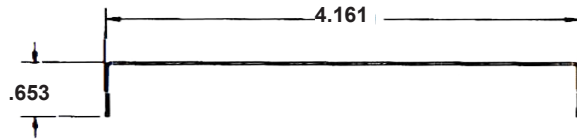
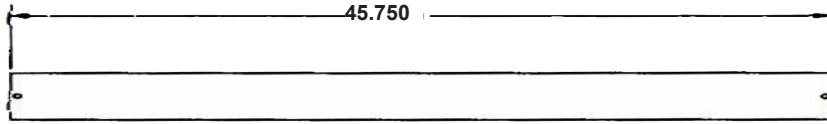

End Socket Bars

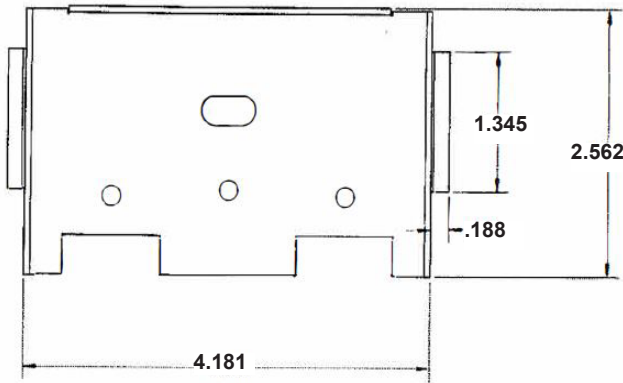

Center Socket Bar

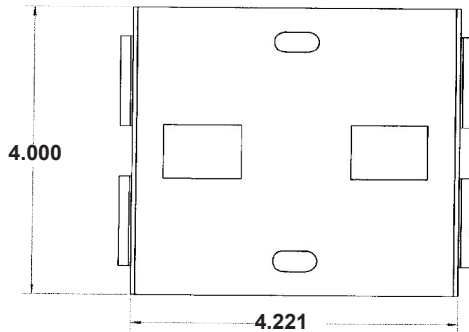

CATALOG#: _____
PROJECT: _____
TYPE: _____

ORDER INFORMATION

SERIES	# OF LAMPS	LAMP TYPE	STRIP LENGTH	REFLECTOR/BALLAST COVER	SOCKET TYPE	BALLAST TYPE
RKITB	1 1 lamp	32 T8	Blank 4" Strip 8 8" Tandem Strip	W10 High Reflectivity White M20 High Reflectivity Silver	L10 For Double Ended Lamp L11 For Single Ended Lamp	XX No Wiring X1 Single Ended LED T8 X2 Double Ended LED T8
	2 2 lamps	28 T5 54 T5HO				

# OF LAMPS	
Blank	Components Bulk Packed and Unassembled
WR	Wire Ballasts and Socket Together

Note:

*Programmable LED drivers allow custom configured wattages and corresponding lumens.

We reserve the right to change design, materials, LED's and finish in any way that will not alter installed appearance or reduce function and performance.



Texas Fluorescents
Reinvented

CATALOG#: _____
PROJECT: _____
TYPE: _____

Series RKITB

Retrofit Kit for Recessed Linear



X1 LED

The most economical, practical and user friendly series of LED fixtures with the energy savings, quality of light, long life and hassle-free maintenance. X1 LED fixtures are UL Listed with the latest LED T8 Bypass lamps. Fixtures provide over 44% energy savings over comparable fluorescent fixtures utilizing less expensive fixtures than the fluorescent version (no ballast required) and have flexibility to change wattage and color temperature any time. Fixture performance will evolve over time with the evolution of the T8 LED lamp technology. Concerned about maintenance with an LED array and driver fixture, X1 LED solves that by utilizing a self contained LED lamp that fits into fixture just like a fluorescent lamp.

Lamp Specifications:

Our T8 LED lamps are available in 2 or 4 ft sizes in different wattage, lumens and color temperature options. Savegreen Lighting is a premier supplier of LED T8 lamps and makes a variety of Bypass T8 lamps to meet the needs of your special application. Options include more energy efficient 12W, 15W and 17W lamps with Premium 10 Year warranty as well as high output options up to 3500 lumens. Double ended LED T8 lamps are also available. See lamp options and specs at www.savegreenlighting.com.

Optional Dimming Options:

The 4 FT lamps are available with two dimming options; Specially designed dimming lamps require an external driver that runs 1 or 2 lamps. So more than 2 lamps require multiple external drivers or Consult for Bypass Type B lamps that can be dimmed without any external driver and dim with standard 2 wire dimming. See dimming options and specs at www.saylite.com.

Emergency Options:

The standard X1 LED Lamps require an inverter or an All-in-one emergency kit that includes LED array, battery and driver. Dimmable T8 LED with external driver works with standard LED EM. For a 5 watt inverter that is similar to adding a 500 Lumen emergency in a conventional fluorescent fixture, add "INV5W" to the end of the item number. This will allow 5 watts of one lamp to work in emergency mode. Or add "EMKT12" to the end of the item number to get a 12W stand alone emergency kit in the fixture that comes with a driver, battery and small LED array that works in Emergency mode. See emergency options and specs at www.saylite.com.

Ordering Options

(Fixtures below include LED T8 Lamp LT8ABP48L18W2250LXXK. For Other Lamp Options See below and Replace LNXXX with short code below. Specify without Lamps by removing LNXXX)

LN18W40 - Lamp Specification
 50,000 Hour Life with 5 Year Warranty
 Beam Angle 140 Degree
 Aluminum Base and Aluminum Housing with Glass Cover
 Operating Temperature: - 20C to 50C
 Color Temperature: 3500K, 4000K, 5000K
 G13 Pins (Same as Fluorescent Linear T8 Bipin)
 AC100 – 277V without Ballast
 Single Ended or Double Ended Power (If not specified use X1 Single Ended Power)



Savegreen T8 or T5 LED Lamp Options

To include one of these lamps in fixture, remove "LNXXX" and add Savegreen Inside code below.
(See www.savegreenlighting.com for specification sheets or more information on these lamp options.)

VERSION	SAVEGREEN INSIDE	SAVEGREEN ITEM NO.
Popular	SGB15W35	LT8BG48L15W1740LXXK
Standard	SGS29W35	LT8BGC24L9W1050LXXK
Standard	SGS312W35	LT8BGC36L12W1200LXXK
Standard	SGS15W35	LT8BGC48L15W1740LXXK
Premium	SGP12W35	L10T8BGC48L12W1750LXXK
Premium	SGP15W35	L10T8BGC48L15W2000LXXK
Premium	SGP18W35	L10T8BGC48L18W2500LXXK
High Output	SGH26W40	LT8BGC48L26W3500LXXK
Double Ended	SGD18W35	LT8BDGC48L18W2100LXXK
T5HO	SGT525W40*	LT5BG46L25W3300LXXK
Magic	SGM18W35K	LT8ABP48L18W2250LXXK
Magic	SGM18W35K	LT8ABP48L15W1875LXXK
Magic	SGM215W35K	LT8ABP24L15W1875LXXK

10-YEAR
WARRANTY

Change 35 to 40 or 50 for different Kelvin.
*For T5, CCT 40K and 50K available.

