

WLIN

Direct/Indirect Wall Mount



FEATURES & SPECIFICATIONS

INTENDED USE

Specification grade, low profile direct / indirect wall mount with up and forward throw optics, the WLIN is a sleek wall mount companion to the pendant mount indirect LIN (see T02PEND, LIN series). This wall mount is ideal for brightening perimeters of offices or spectacular wall lighting systems for corridors.

SIZE W x L x H in inches (mm)

5.03W x 49.25L x 2.68Dp (130 x 1250 x 70)

5.03W x 98.00L x 2.68Dp (130 x 2490 x 70) Tandems

LAMP

2 lamp positions.

MATERIALS & FEATURES

Housing is die-formed and embossed code 20 gage steel with die cast aluminum end caps. Standard finish is powder coat white. Custom colors available. An enhanced white aluminum reflector is included.

- CONTINUOUS ROW MOUNTING
- POST PAINTED POWDER COAT FINISH
- White standard, Custom colors available

MOUNTING

Wall bracket mount.

LISTING

Fixture and Ballast: UL Listed.

Ballast: Thermally protected, class P, HPF, Non PCB.

TYPICAL OPTIONS AND ACCESSORIES

Emergency ballasts and custom colors.

Companion wall mount fixture to the LIN series direct / indirect pendant.

ORDERING INFORMATION

Example: WLINPF2 328E120

WLIN	PF	2	32	8	E120	Finish				
Series		Lamp Count			Lamp Type		Tandem Code			
WLIN		(lamps not included)								
Direct/Indirect		2	32	48in. T8						
\Wall Mount		2	32	48in. T8	8	8ft. Tandem (4 lamp positions total)				
\LIN Companion		2	28	46in. T5						
		2	28	46in. T5	8	8ft. Tandem (4 lamp positions total)				
		2	54	46in. T5HO						
		2	54	46in. T5HO	8	8ft. Tandem (4 lamp positions total)				
Body Style		Function						Ballast Type		
PF	Perforated	Blank	Standard Fixture includes end caps				E120	Electronic, 120V		
SD	Solid	J	Joiner -No end caps are furnished with joiner sections				E277	Electronic, 277V		
MW	White Lens								MV	Electronic, Multivolt (120-277)
LV	Louver									
		Finish								
		Blank		White (standard)						
		Custom colors available								

See end of section for additional ballasts, finish codes, and options.

NO END CAPS ON JOINER SECTIONS.

The WLIN series may be mounted in continuous rows.

One pair of end caps are required per row.

For individual mount, order standard fixture.

For a continuous row, order one standard & balance as joiners.



Texas Fluorescents
Reinvented

WLIN

Direct/Indirect Wall Mount

DIMENSIONS

All dimensions are inches. Specifications subject to change without notice.

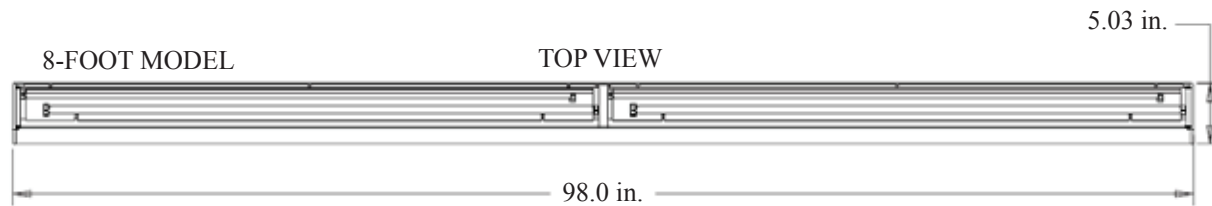
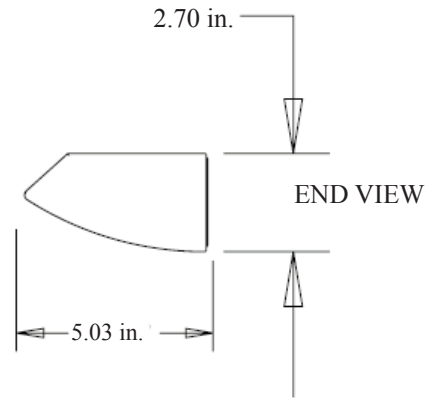
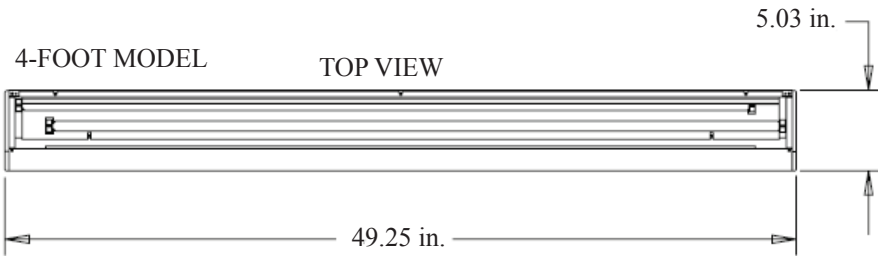

LIN Series



Mounted on Ceiling

WLIN Series



Mounted on Wall

* Companion to the LIN series pendant mount indirect

Catalog Number:
Notes: