



Texas Fluorescents
Reinvented

CATALOG#: _____
PROJECT: _____
TYPE: _____

Series UCLL

LED Low Profile Center Basket Recessed

Low profile, center-lensed LED fixtures ideal for shallow plenum spaces. Specification grade, direct/indirect center diffuser luminaire provides smooth and uniform ambient lighting for all commercial and industrial buildings with recessed configurations. Reflected light from matte surface adds a softened “sky light” appearance to the modern office environment. Linear ribbed lens encloses the LED array and is designed to maximize efficiency and minimize glare.

CONSTRUCTION

Housing is die-formed and embossed 20 gauge steel. Luminaire body finish is high reflectance baked white enamel, with matte white reflectors. Wiring knockouts are provided on the back of housing and ends of fixture. Center diffuser snaps into place; no tools are required for removal. Diffuser is ribbed acrylic lens providing increased light output.

MOUNTING

Recessed inverted T-Bar ceilings. Grid mount or surface mount.



DIMENSIONS

- 1x1 - 11.85"L x 11.85"W x 3.25"H
- 1x2 - 24"L x 12"W x 3.25"H
- 1x4 - 47.8"L x 11.7"W x 3.25"H
- 2x2 - 24"L x 24"W x 3.25"H
- 2x4 - 48"L x 24"W x 3.25"H

FEATURES & BENEFITS

- Designed to minimize glare, producing a soft, "sky light" appearance for modern spaces
- Fifteen lumen packages/wattages across 5 fixture sizes
- Matte white reflective surfaces for soft, uniform light distribution
- Available in 4 color temperatures ranging from 3000K - 5000K
- For use in recessed inverted T-Bar or grid ceilings
- Specifically designed lens (LL) for LED array to provide enhanced light transmission while minimizing glare and LED diode shadows
- Emergency battery backup available
- CRI >80 standard, 90 optional
- L70: >50,000 Hours
- Dimming: 0-10V
120-277V standard,
120 ELV/TRIAC optional
- Power factor >0.90
- IC Rated for dry and damp locations
- 5 year warranty



ORDER INFORMATION

Factory at your fingertips. Fill in the blanks to create your part number or create a custom configuration.

SERIES	LENS MATERIAL	LENGTH	WATTAGE* & LUMENS*	DRIVER
UC Center Basket Grid Mount	LL Linear Ribbed Lens	11L¹ 11.85" x 11.85"	F11W1250L 11 Watts, 1250 Lumens	DMV 0-10V Dimming
	PF Perforated Basket [^]		F22W2500L 22 Watts, 2500 Lumens	
UCR Center Basket w/Air Return	PF Perforated Basket [^]	12L¹ 12" x 24"	J24W2700L 24 Watts, 2700 Lumens	G120 ELV/TRIAC Dimming at 120V only
			D1MV 0-10V Dimming (dim to 1%) (only available with SS sensor)	
SSUC Center Basket Sensor - On/Off	PF Perforated Basket [^]	14L 11.7" x 47.8"	J32W3600L 32 Watts, 3600 Lumens	DMV (xx) 0-10V Dimming (xx) for percentage of light output when not occupied. (required for SV sensor)
			J32W4300L 32 Watts, 4300 Lumens	
SVUC Center Basket Bi-Level (xx)	PF Perforated Basket [^]	22L 24" x 24"	J48W6050L 48 Watts, 6050 Lumens	
			J24W2700L 24 Watts, 2700 Lumens	
SDUC Center Basket Daylight Harvesting	PF Perforated Basket [^]	24L 24" x 48"	J28W3150L 28 Watts, 3150 Lumens	
			J32W3600L 32 Watts, 3600 Lumens	
			J42W4300L 42 Watts, 4300 Lumens	
			J48W6000L 48 Watts, 6000 Lumens	
			J32W4350L 32 Watts, 4350 Lumens	
			J40W5350L 40 Watts, 5350 Lumens	
			J48W6100L 48 Watts, 6100 Lumens	
			J57W6800L 57 Watts, 6800 Lumens	

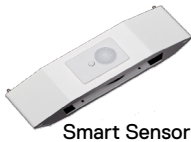

Smart Sensor

[^] Note: Lumen output falls to approximately 60% with the perforated basket, as compared with the linear lens lumen levels stated at right.

COLOR/CRI**	OPTIONS
30K 3000K 80 CRI	WP 6 ft. 3 wire 18 gauge whip (non-dimming) GK1 Single gasket (lens to door frame)
35K 3500K 80 CRI	WP4 6 ft. 4 wire 18 gauge whip (non-dimming EM) GK2 Double gasket (lens/frame + frame to troffer)
40K 4000K 80 CRI	WP5W 6 ft. 5 wire 18 gauge whip GK3 Triple gasket (lens/frame + frame/troffer + troffer to T-grid)
50K 5000K 80 CRI	WP6W 6 ft. 6 wire 18 gauge whip (dimming EM) FIK1x4 1x4 Frame-in-kit
930K 3000K 90 CRI	EM Integrated 10W Emergency battery backup (excludes 1x4, 1x2, and 1x1) FIK2x2 2x2 Frame-in-kit
935K 3500K 90 CRI	EM12 12W Emergency battery backup (remote only) FIK2x4 2x4 Frame-in-kit
940K 4000K 90 CRI	EM20 20W Emergency battery backup (remote only) CP Chicago Plenum
950K 5000K 90 CRI	

Note:

*Programmable LED drivers allow custom configured wattages and corresponding lumens.

** Consult factory for 90 CRI 5000K availability.

¹Remote EM only. Not available for sensor options.

We reserve the right to change design, materials, LEDs and finish in any way that will not alter installed appearance or reduce function and performance.

DRAWINGS & IMAGES

SIDE

1X1

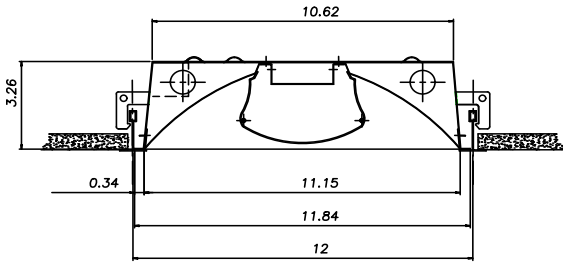

BACK

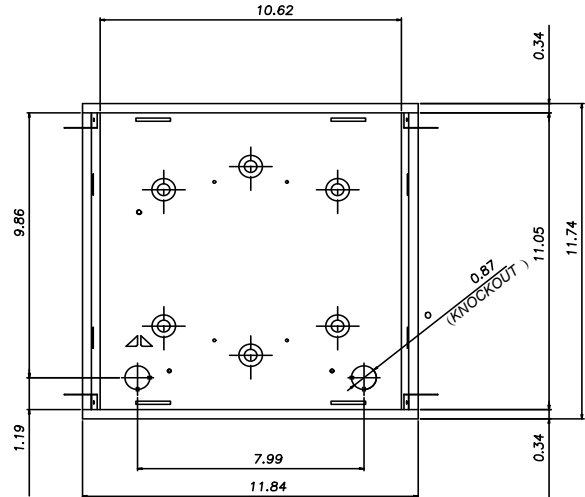

1X2

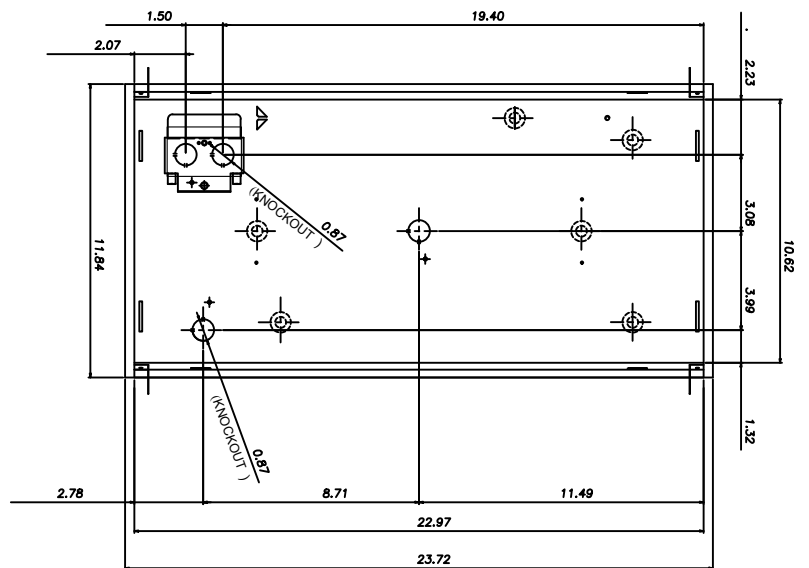
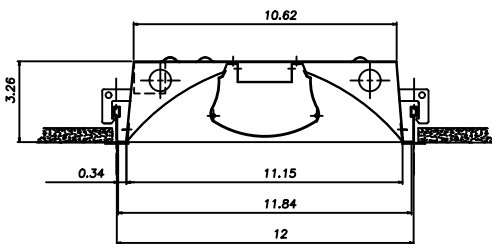

DRAWINGS & IMAGES

SIDE

1x4

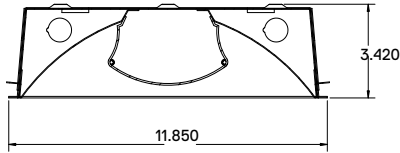

2x2

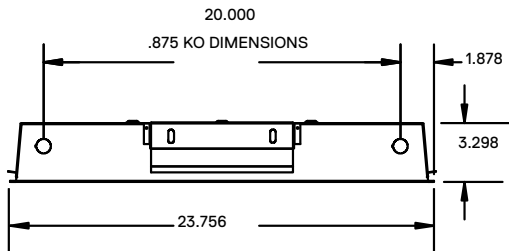

2x4

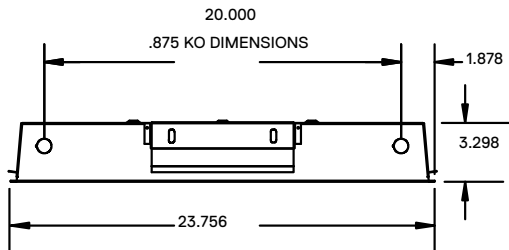

BACK

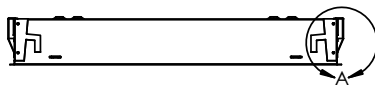
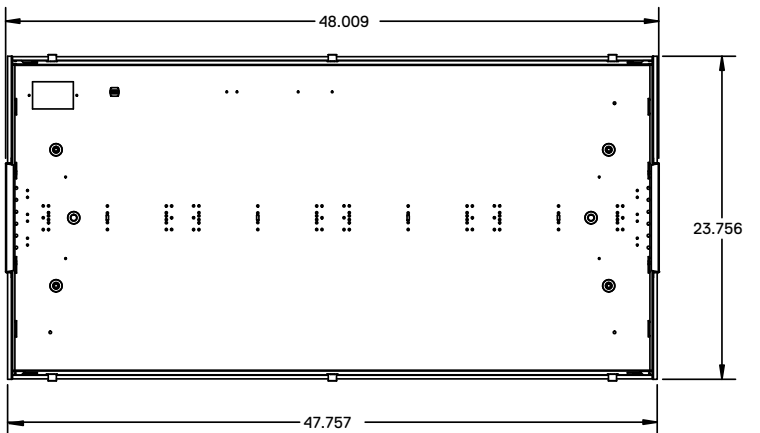
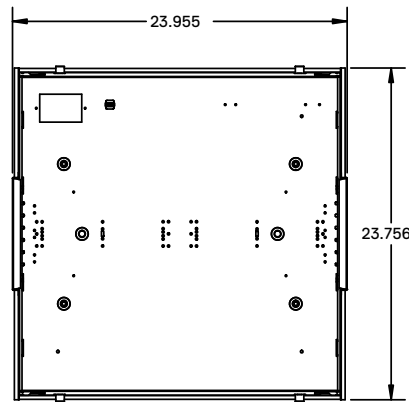
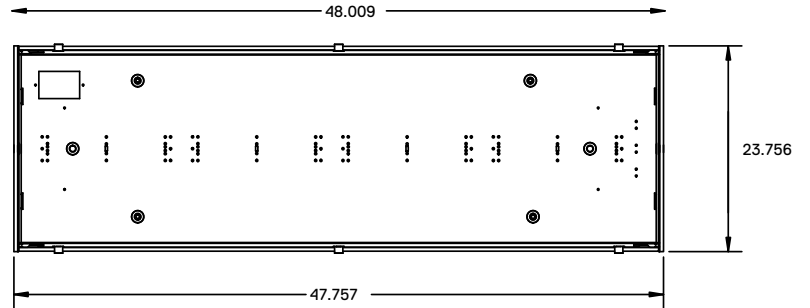

Bend out to engage earthquake hook

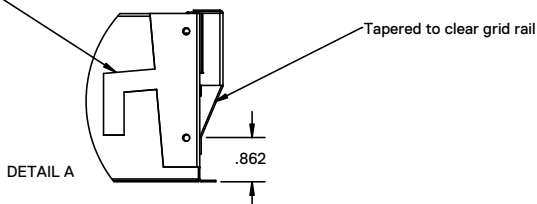

Replacement Lens Ordering Information

Series	Description
0UCLL1x4	Replacement lens for 1x4
0UCLL2x2	Replacement lens for 2x2
0UCLL2x4	Replacement lens for 2x4

Photometric

1x4-UCLL14LJ48W6000LDMV40K

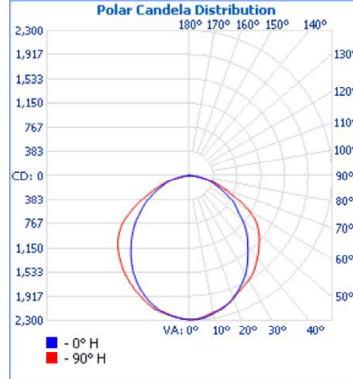
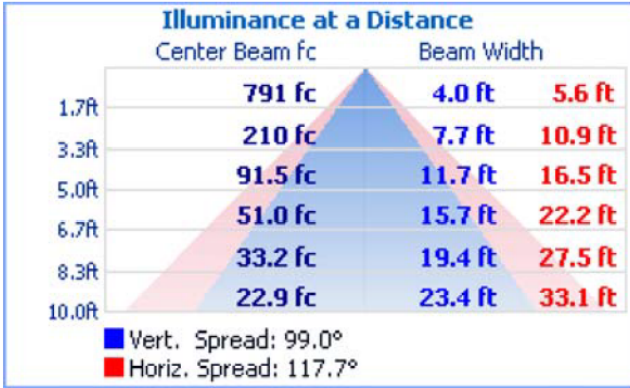

Zonal Lumen Summary

Zone	Lumens	%Luminaire
0-30	1,732.1	28%
0-40	2,812.3	45.4%
0-60	4,942.0	79.8%
60-90	1,247.5	20.1%
70-100	501.2	8.1%
90-120	1.6	13.9%
0-90	6,189.4	100%
90-180	1.6	0%
0-180	6,191.0	100%

2x2-UCLL22LJ28W3150LDMV40K

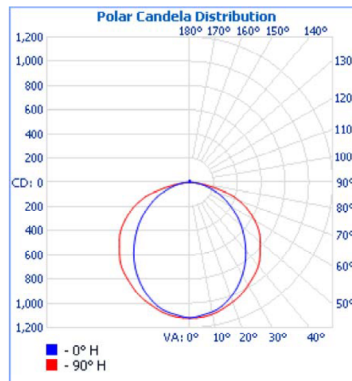
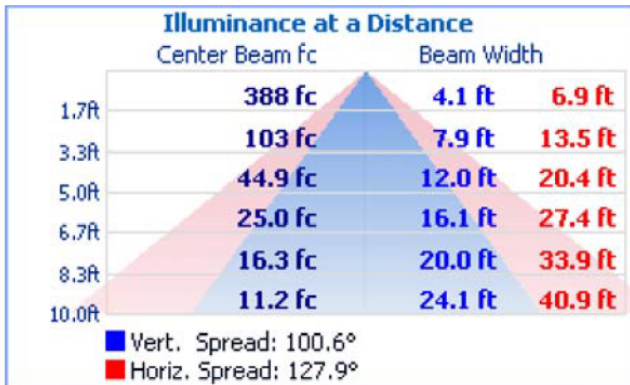

Zonal Lumen Summary

Zone	Lumens	%Lamp	%Luminaire
0-30	861.7	26.8%	26.3%
0-40	1,408.0	43.8%	43%
0-60	2,507.8	78%	76.7%
60-90	740.1	23%	22.6%
70-100	318.9	9.9%	9.7%
90-120	6.6	0.2%	0.2%
0-90	3,247.9	101%	99.3%
90-180	23.4	0.7%	0.7%
0-180	3,271.3	101.7%	100%

2x4-UCLL24LJ57W6800LDMV40K

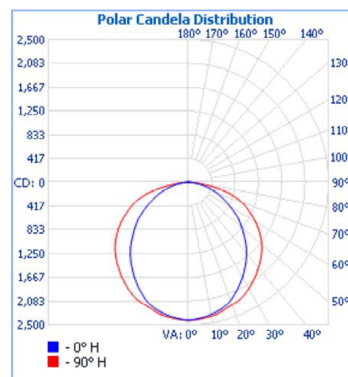
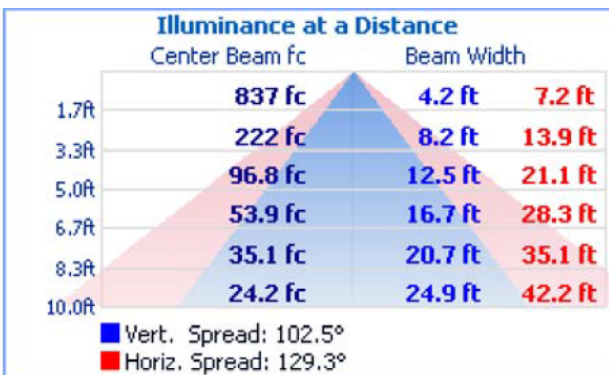

Zonal Lumen Summary

Zone	Lumens	%Luminaire
0-30	1,873.1	25.7%
0-40	3,074.1	42.2%
0-60	5,519.6	75.8%
60-90	1,761.3	24.2%
70-100	800.3	11%
90-120	1.6	0%
0-90	7,280.9	100%
90-180	2.5	0%
0-180	7,283.4	100%



Texas Fluorescents
Reinvented



CATALOG#: _____

PROJECT: _____

TYPE: _____

Series UCLL

LED Low Profile Center Basket
Recessed

DLC Listed Items

1X4 ITEM NUMBER	2X2 ITEM NUMBER	2X4 ITEM NUMBER
UCLL14LJ32W4300LDMV30K	UCLL22LF28W3500LDMV30K(WP,EM)	UCLL24LF28W2700LDMV30K
UCLL14LJ32W4300LDMV35K	UCLL22LF28W3500LDMV35K(WP,EM)	UCLL24LF32W3450LDMV30K
UCLL14LJ32W4300LDMV40K	UCLL22LF28W3500LDMV40K(WP,EM)	UCLL24LF32W3450LDMV35K
UCLL14LJ32W4300LDMV50K	UCLL22LF28W3500LDMV50K(WP,EM)	UCLL24LF32W3450LDMV40K
UCLL14LJ40W5250LDMV30K	UCLL22LF30W3600LDMV30K(WP,EM)	UCLL24LF32W3450LDMV50K
UCLL14LJ40W5250LDMV35K	UCLL22LF30W3600LDMV35K(WP,EM)	UCLL24LF48W4800LDMV30K
UCLL14LJ40W5250LDMV40K	UCLL22LF30W3600LDMV40K(WP,EM)	UCLL24LF48W4800LDMV35K
UCLL14LJ40W5250LDMV50K	UCLL22LF30W3600LDMV50K(WP,EM)	UCLL24LF48W4800LDMV40K
UCLL14LJ48W6000LDMV30K	UCLL22LJ24W2700LDMV30K	UCLL24LF48W4800LDMV50K
UCLL14LJ48W6000LDMV35K	UCLL22LJ24W2700LDMV35K	UCLL24LF57W5400LDMV30K
UCLL14LJ48W6000LDMV40K	UCLL22LJ24W2700LDMV40K	UCLL24LF60W6000LDMV30K
UCLL14LJ48W6000LDMV50K	UCLL22LJ24W2700LDMV50K	UCLL24LJ32W4350LDMV30K
UCLL14LJ57W6700LDMV30K	UCLL22LJ28W3150LDMV30K	UCLL24LJ32W4350LDMV35K
UCLL14LJ57W6700LDMV35K	UCLL22LJ28W3150LDMV35K	UCLL24LJ32W4350LDMV40K
UCLL14LJ57W6700LDMV40K	UCLL22LJ28W3150LDMV40K	UCLL24LJ32W4350LDMV50K
UCLL14LJ57W6700LDMV50K	UCLL22LJ28W3150LDMV50K	UCLL24LJ40W5350LDMV30K
UCLL22LF20W2450LDMV30K(WP,EM)	UCLL22LJ32W3600LDMV30K	UCLL24LJ40W5350LDMV35K
UCLL22LF20W2450LDMV35K(WP,EM)	UCLL22LJ32W3600LDMV35K	UCLL24LJ40W5350LDMV40K
UCLL22LF20W2450LDMV40K(WP,EM)	UCLL22LJ32W3600LDMV40K	UCLL24LJ40W5350LDMV50K
UCLL22LF20W2450LDMV50K(WP,EM)	UCLL22LJ32W3600LDMV50K	UCLL24LJ48W6100LDMV30K
UCLL22LF24W3000LDMV30K(WP,EM)	UCLL22LJ42W4300LDMV30K	UCLL24LJ48W6100LDMV35K
UCLL22LF24W3000LDMV35K(WP,EM)	UCLL22LJ42W4300LDMV35K	UCLL24LJ48W6100LDMV40K
UCLL22LF24W3000LDMV40K(WP,EM)	UCLL22LJ42W4300LDMV40K	UCLL24LJ48W6100LDMV50K
UCLL22LF24W3000LDMV50K(WP,EM)	UCLL22LJ42W4300LDMV50K	UCLL24LJ57W6800LDMV30K