

### FEATURES & SPECIFICATIONS

#### INTENDED USE

The H6L series is the workhorse of our high bay fluorescent series, designed especially for high light output. The fixtures uses premium mirrored or white reflectors for high efficiency lighting. A sturdy/ durable fixture body with superior appearance and appeal, suitable for commercial, retail and industrial applications. Mounts easily with chain or cable kit. The Smart Sense version incorporates an integral Sensor Switch Occupancy Sensor in the reflector and protected by an optional wire guard. No need for an external sensor with this full functioning Occupancy Sensor. See Sensor Switch spec sheet below.

Also available in **TANDEM** configuration.

#### SIZE W x L x H in inches (mm)

15.8W x 48L x 3.4Dp

15.8W x 96L x 3.4Dp

#### CONSTRUCTION

Body and ends are die blanked, pierced and formed of 20 guage cold rolled prime steel for rigidity and uniformity. Forming of the housing has been engineered to provide added strength along its entire length.

#### LAMP

6 Lamp Positions; T5 or T8. Consult for 4 lamp.

#### MATERIALS & FEATURES

Baked white enamel code gage steel Premium full specular mirrored reflector Multiple KOs and access plate.



Integral Sensor Switch  
Occupancy Sensor

#### MOUNTING

4 Point chain mount. For other options, consult factory.

#### LISTING / CERTIFICATIONS

Fixture & Ballast: UL Listed

#### TYPICAL OPTIONS AND ACCESSORIES

Emergency ballasts, Cord sets, whips, occupancy sensors Hanging kits, Wire guards. Contact factory for additional options.

### ORDERING INFORMATION

Example: **H6L654M23MV**

H6L	6	54	M23	MV
<b>Series</b>	<b>Lamp Type</b>		<b>Reflector</b>	<b>Ballast &amp; Voltage [1]</b>
H6L High Bay Workhorse SSH6L Smart Sense High Bay	54 46 in. T5 32 48 in. T8		M23 Mirrored wide distribution W13 Enhanced white Aluminum W12 Enhanced white Reflector w/ integral sensor and air vents.	E120 Electronic, 120V E277 Electronic, 277V MV Electronic, Multivolt (120-277) H120 Electronic, 120V Hi-Lume [3] H277 Electronic, 277V Hi-Lume [3] HMV Electronic, MV Hi-Lume [3] L120 Electronic, 120V Lo-Lume [3] L277 Electronic, 277V Lo-Lume [3] LMV Electronic, MV Lo-Lume [3] PMV* Electronic, Program Start 120-277V
	<b>Lamp Count</b>		<b>Tandem Code</b>	<b>Options [1]</b>
	4 6 (Lamps not included)		Blank No Tandem 8 8 ft. Tandem (double lamp count)	CS 5-15P 120V 8ft. Cord & Plug CS12 L7-15P 277V 8ft. Cord & Plug CS08 8ft. Cord, No Plug WP 6 ft. 3 wire, Whip WP10 6ft. 4 wire, Whip EM Emergency ballast, 500 lumens EM14 Emergency ballast, 1400 lumens
<b>Accessories</b>	<b>Order as Seperate Part Number</b>			
H6LLEN Clear Lens. Mounts .25" off fixture. HC101 Chain kit, Includes: 6 S Hooks and 20ft. chain HC202 Tong hangers, End Mount (Pair) HC203 Tong hangers, Side Mount (Pair) 7H6L Single Point hanger adapter H6L6WG 6 Lamp Wire Guard				

Consult for cord, hanging and occupancy sensor options.

Note: EM14 required for T5HO lamps  
\*Recommended with T8 lamps and SS series

# Smart Sense H6L Series

H6L High Bay Workhorse



Integral Sensor Switch  
Occupancy Sensor

## DIMENSIONS

Top View

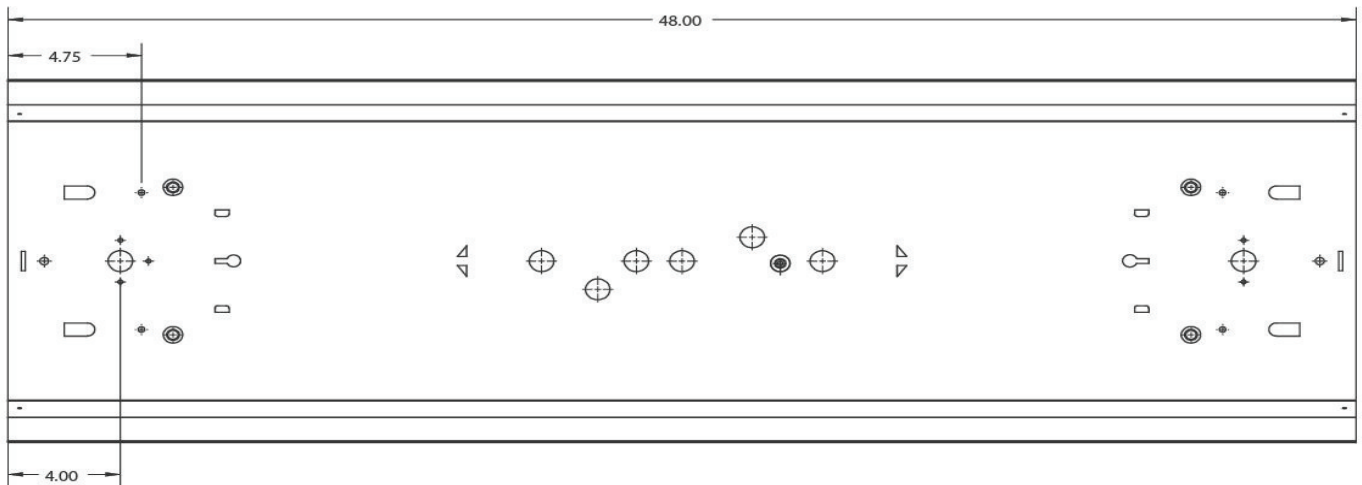



## HIGH BAY 360° SENSOR SNAP FIT ENCLOSURE • LINE VOLTAGE • PASSIVE INFRARED

### SPECIFICATIONS

#### FEATURES

- Self-Contained Relay,  
No Power Pack Needed
- No Minimum Load Requirements
- Interchangeable Hot & Load Wires,  
Impossible to Wire Backwards
- Push-Button Programmable  
Adjustable Time Delays
- No Field Calibration or Sensitivity  
Adjustments Required
- Convenient Test Mode
- 100 hr Lamp Burn-in Timer
- Green LED Indicator

#### LAMPMAXIMIZER® TECHNOLOGY

- Protects Lamp Life while  
Maximizing Energy Savings
- Minimum On Timer (15 min default)
- Occ. Time Delay (10 min default)

#### PHYSICAL SPECS

- SIZE 2.25" H x 1.38" W x 0.82" D  
(5.715 cm x 3.51 cm x 2.08 cm)
- WEIGHT 4 oz.
- MOUNTING Snaps into 2 3/16" H x  
1 5/16" W x 1" D cavity in fixture
- COLOR White

#### ELECTRICAL SPECS

- LOAD RATING (1 PHASE ONLY)
  - 800 W @ 120 VAC
  - 1200 W @ 277 VAC
  - 1500 W @ 347 VAC
- MOTOR LOAD 1/4 HP
- FREQUENCY 50/60 Hz
- Timers are 1.2x for 50 Hz

#### ENVIRONMENTAL SPECS

- OPERATING TEMP  
14° to 160° F (-10° to 71° C)
- STORAGE TEMP  
-14° to 160° F (-26° to 71° C)
- RELATIVE HUMIDITY  
20 to 90% non-condensing
- SILICONE FREE
- ROHS COMPLIANT

#### OVERVIEW

The Snap-Fit High Bay sensor is a compact line voltage sensor that snaps directly into a small cavity in a fixture. The sensor utilizes Passive Infrared (PIR) detection to detect motion from occupants within its 360° coverage pattern that overlaps that of most HID, T-5, or T-8 fixtures used in warehouse applications.

#### SENSOR OPERATION

The sensor detects changes in the infrared energy given off by occupants as they move within the field-of-view. When occupancy is detected, a self-contained relay switches the connected lighting load on. The sensor is line powered, switches line voltage, and requires no field calibration or sensitivity adjustments.

#### LAMPMAXIMIZER®

This sensor also contains patent pending LampMaximizer technology that allows users to aggressively target energy savings while still protecting lamp life. A minimum on timer, factory set at 15 minutes, helps preserve lamp life by eliminating all lamp cycles shorter than lamp manufacturers' recommendations.

A standard occupancy time delay is also present that ensures lights turn off (assuming minimum on timer has elapsed) if no occupancy is detected. This timer is factory set at 10 minutes to promote energy savings, but is adjustable between 30 seconds and 20 minutes. These adjustments can be done manually, through the unit's push-button; no tools required.

### OPTIONS

#### 347 VAC (347)

- Allows sensor to be powered from and switch 347 VAC

#### LOW TEMP/HIGH HUMIDITY (LT)

- Sensor is corrosion resistant to moisture
- Operates down to -40° F/C



TITLE 24  
ASSEMBLED in U.S.A.  
5 YEAR WARRANTY

### ORDERING INFO SFR 5 [VOLTAGE] [TEMP/HUMIDITY]

#### VOLTAGE

Blank = 120/277 VAC  
347 = 347 VAC

#### TEMP/HUMIDITY

Blank = Standard  
LT = Low Temp

## COVERAGE PATTERN

### 5 MINI HIGH BAY 360° LENS

- Recommended for fixtures that have a 1.0 spacing to mounting height ratio or less (e.g. fixtures 30' on center or less @ a 30' mounting height).
- Recommended for mounting heights between 30 to 45 ft (9.14 to 13.72 m) only
- 15 to 20 ft (4.57 to 7.62 m) radial coverage overlaps area lit by a typical high bay fixture
- Excellent detection of large motion (e.g. walking) up to a 35 ft (10.67 m) mounting height
- Excellent detection of extra large motion (e.g. forklifts) up to a 45 ft (13.72 m) mounting height

#### MASKING KIT

- A masking kit is provided in order to mask off a portion of the view pattern for end-of-aisle applications; or to trim the sensor's side viewing to create a rectangular pattern for center-of-aisle viewing only.

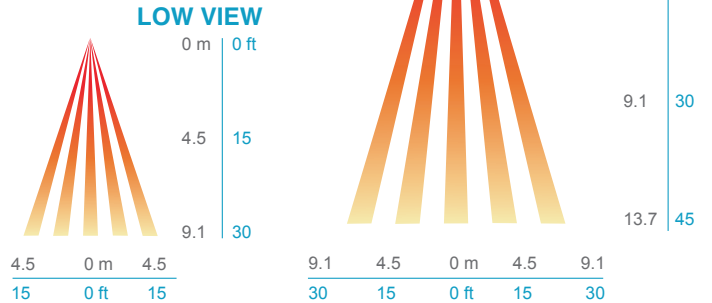
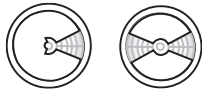

## WIRING (DO NOT WIRE HOT)

#### STANDARD WIRING

- BLACK\* - Line Input
  - BLACK\* - Load Output
  - WHITE - Neutral
- \*BLACK wires can be reversed

#### 347 VAC OPTION

Black wires are replaced w/ Red wires

#### INITIAL POWER UP (3 MINUTE WARM-UP)

The relay in the sensor is shipped in a latched closed position so that when power is initially applied the lights will come on. The sensor will then begin to time out after a 1-3 minute warm-up period. If the lights do not immediately turn on (initial installation only) the latching relay opened during shipment and will close after warm-up period is over.

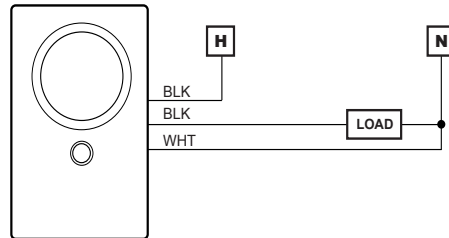

## INSTALLATION

#### MOUNTING

- The snap fit enclosure is designed to fit snugly inside a 2 3/16" H x 1 5/16" W x 1" D cavity in a low bay lighting fixture.

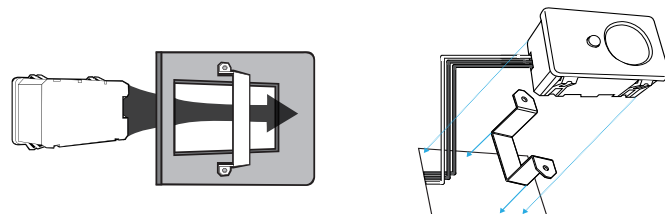
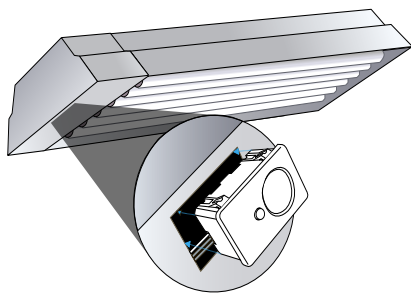

Diagrams show internal cross section of fixture with bracket included for additional sensor impact strength.

- For optimal detection, position sensor such that segments are crossed upon entrance and unable to view outside the space

#### PROGRAMMING

Refer to instruction card IC1-002 for default settings and directions on programming the sensor via the push-button.

**sensorswitch**

An AcuityBrands Company

**WARRANTY:** Sensor Switch, Inc. warrants these products to be free of defects in manufacture and workmanship for a period of 60 months. Sensor Switch, Inc., upon prompt notice of such defect, will, at its option, provide a Returned Material Authorization number and repair or replace returned product.

**LIMITATIONS AND EXCLUSIONS:** This Warranty is in full lieu of all other representation and expressed and implied warranties (including the implied warranties of merchantability and fitness for use) and under no circumstances shall Sensor Switch, Inc. be liable for any incidental or consequential property damages or losses.

TS-SFR-001A