

Installation Instruction

① Carefully unpack the fixture from its packaging and check contents.

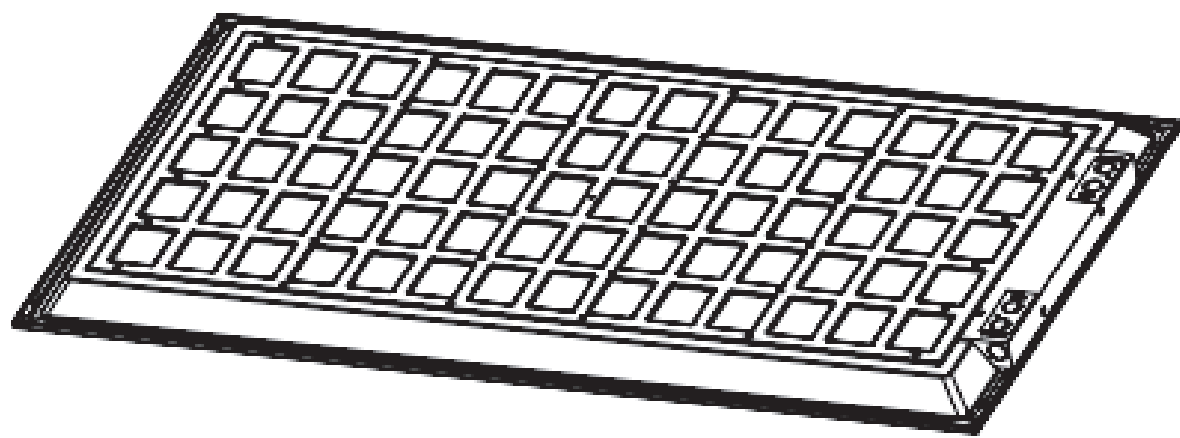

② Turn off power at circuit breaker.



③ Locate all four earthquake clips on the back of luminaire. Twist each tab away from luminaire testing them on the T-bar.

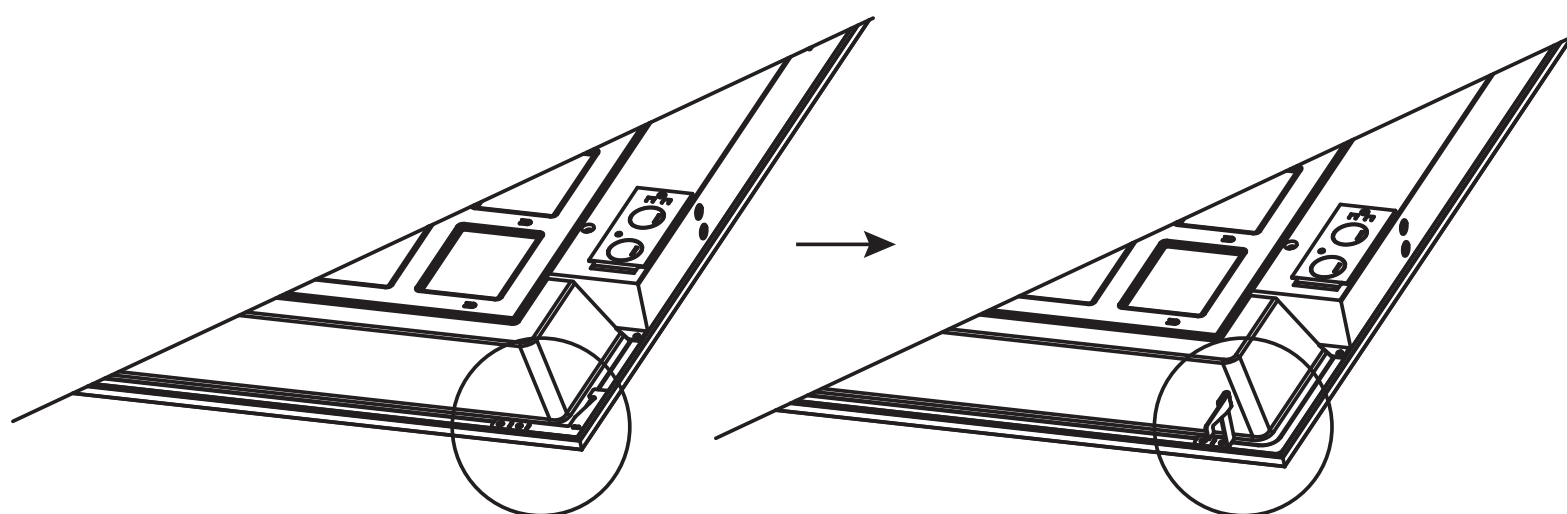

④ Rest the Luminaire on the T-Bar of the ceiling suspension system in the desired location.

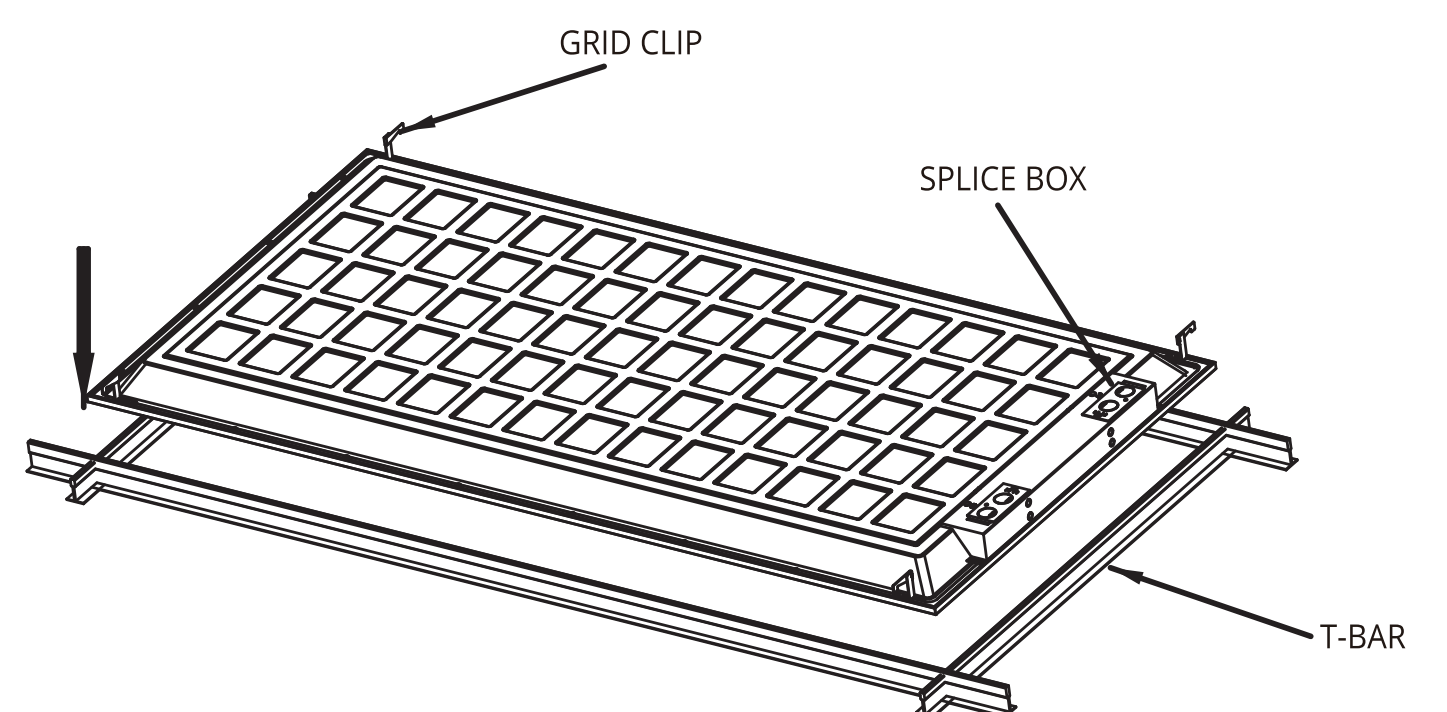

- ⑤ Open the connection box and connect the incoming electrical wires to the set of power wires black to black(Live), white to white(Neutral) and green to green(ground).
See wiring diagram 1;
- ⑥ For 0-10V dimming, make sure connect the same wire color . See wiring

diagram 2

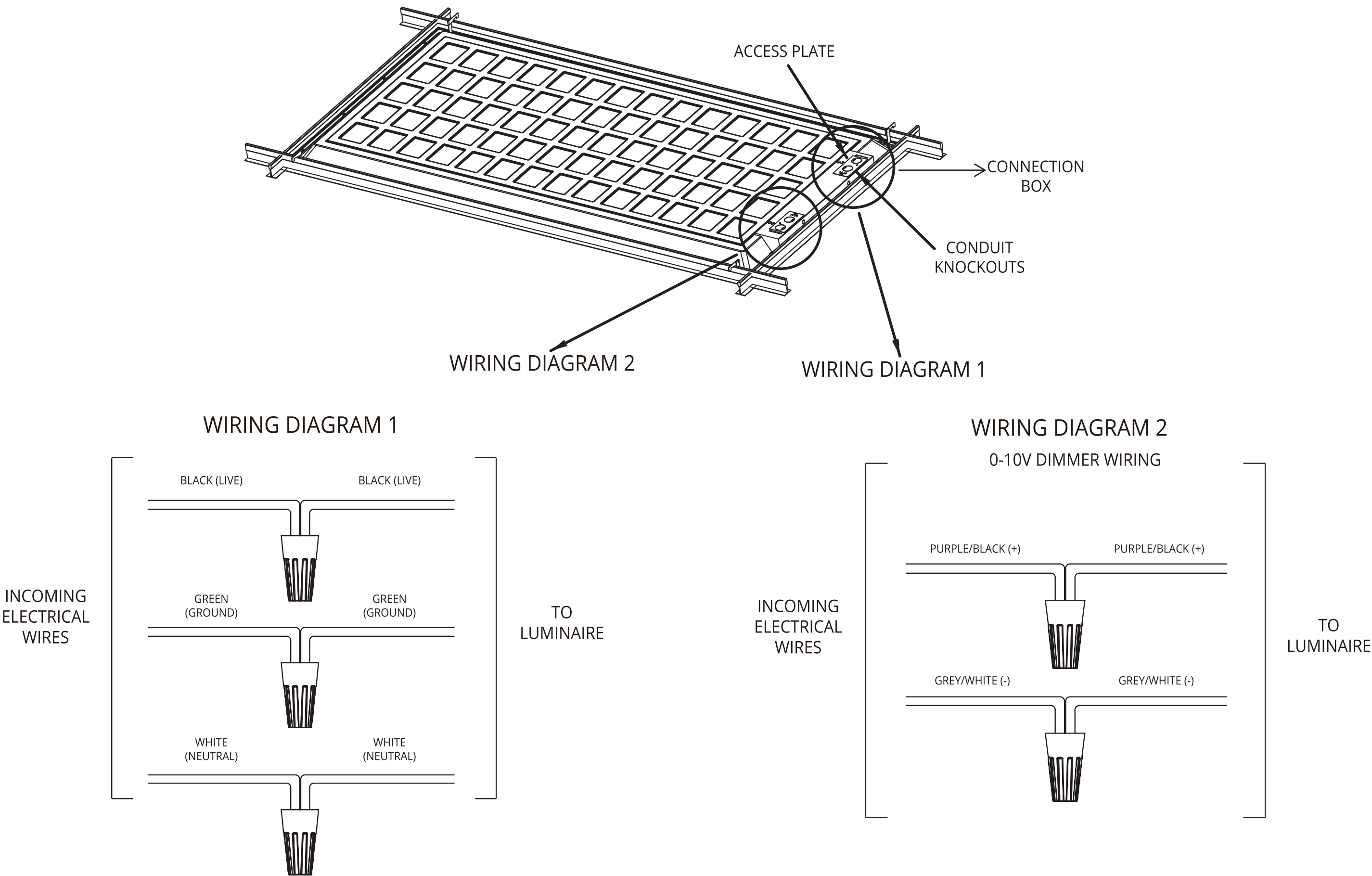

- ⑦ check the wiring, make sure everything is correct. Recover the connection box.
- ⑧ Select the CCT and wattage you need.
- 1X4: 40W-30W-20W,5000k-4000K-3500K

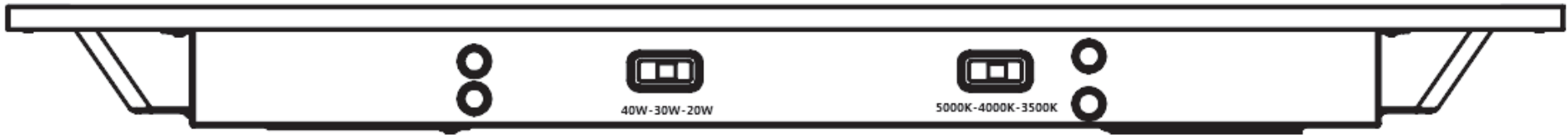

2x2: 40W-30W-20W , 5000K-4000K-3500K

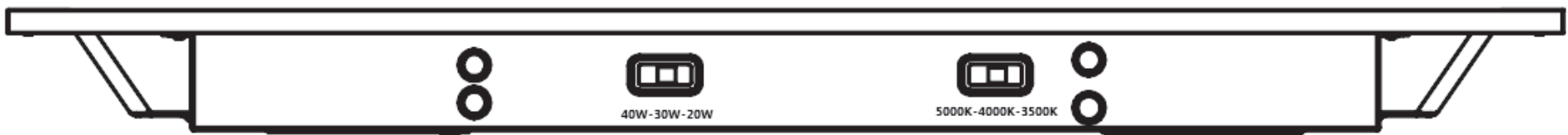

2x4: 50W-40W-30W , 5000K-4000K-3500K

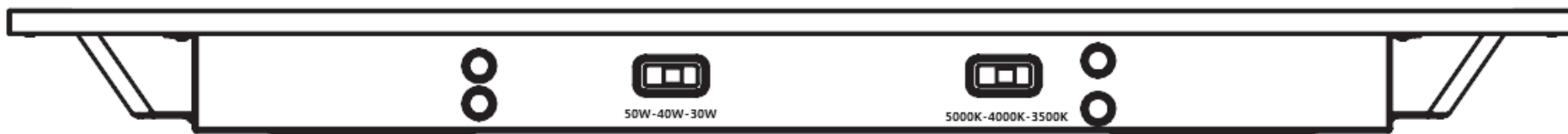

- ⑨ Turn on power to light up the luminaire.