



BOZB1C3 & BOZB2C3

Bozeman Round & Square Low Profile Pathway Bollards



BOZB1C3 - Round Low Profile Pathway Bollard



BOZB2C3 - Square Low Profile Pathway Bollard

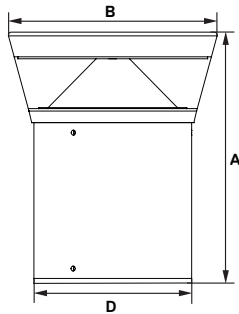

Dimensions	
Width (B)	9 1/4" (234mm)
Diameter (D)	7" (180mm)
Height (A)	10" (254mm)

The SaySpec BOZB1 and BOZB2 Bozeman LED Low Profile Pathway Bollards with UV-stabilized polycarbonate lenses and sealed optical compartments are designed to replace incandescent and halogen pathway lighting. These fixtures are ideal for retail centers, parks, schools and universities, public transit and airports, office buildings and medical facilities.

SPECIFICATIONS AND FEATURES:

HOUSING:

Extruded Aluminum Housing with Flush Mounting Base & Vandal-Resistant Screws, Flat Top, Internal Driver Tray for Easy Maintenance.

LISTING & RATINGS:

CSA: Listed for Wet Locations, ANSI/UL 1598, 8750
IP66 Sealed LED Compartment.

FINISH:

Textured Architectural Bronze or Black Powdercoat Finish Over a Chromate Conversion Coating. Custom Colors Available Upon Request.

REFLECTOR:

Reflective White UV-Stabilized Polycarbonate Cone Reflector

LENS:

Clear UV-Stabilized Polycarbonate Vandal-Resistant Lens

MOUNTING OPTIONS:

Mounting Kit with 8" Anchor Bolts, Included.

COB LED:

Cool Copper COB; 106,000 Hours of L70 LED Life (25°C)

WATTAGE:

Array: 23w, System: 27w; (70w HID Equivalent)

DRIVER:

Electronic Driver, 120-277V, 50/60Hz or 347V, 50/60Hz; Less Than 20% THD and PF>0.90. Standard Internal Surge Protection 2kV. 0-10V Dimming Standard for a Dimming Range of 100% to 10%; Dimming Source Current is 150 Microamps.

WARRANTY:

5-Year Warranty for -20°C to +40°C Environment.

See Page 2 for Projected Lumen Maintenance Table.

Order Information Example:

BOZB1C34X5U41KZ10SF

Model	Wattage	Driver	CCT	Color	Height	Options
BOZB1C3=Bozeman Round Low Profile Pathway Bollard BOZB2C3= Bozeman Square Low Profile Pathway Bollard	4X5=20w	U=120-277V C=347V	41K=4100K	Z=Bronze B=Black C=Custom (Consult Factory)	10=10" C=Custom*	SF=Single Fuse (120-277V Only) SP=Surge Protection

*Consult factory. Minimum NEC requirements for wiring space and above ground level must be met.

Project Information:

PROJECT NAME: _____ FIXTURE TYPE: _____
 COMPLETE CATALOG#: _____ DATE: _____
 COMMENTS: _____

Certification & Listings:





BOZB1C3 & BOZB2C3

Bozeman Round & Square Low Profile Pathway Bollards

ACCESSORIES & REPLACEMENT PARTS:

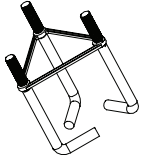

BOLAN

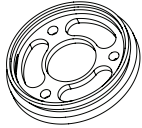

BORBASE

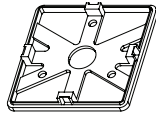

BOSBASE

Mounting Accessories (Order Separately, Field Installed)		Replacement Parts (Order Separately, Field Installed)	
BOLAN4	Mounting Kit, Includes Bracket & Three (3) 4" Anchor Bolts	BORBASE*	Die Cast Base Plate with Powdercoat Finish Over a Chromate Conversion Coating. Fits BOZB1.
BOLAN8	Mounting Kit, Includes Bracket & Three (3) 8" Anchor Bolts	BOSBASE*	Die Cast Base Plate with Powdercoat Finish Over a Chromate Conversion Coating. Fits BOZB2.
BOLAN12	Mounting Kit, Includes Bracket & Three (3) 12" Anchor Bolts		
BOLAN15	Mounting Kit, Includes Bracket & Three (3) 15" Anchor Bolts		

*Specify Color: Z=Bronze, B=Black, C=Custom (Consult Factory)

PHOTOMETRIC DATA

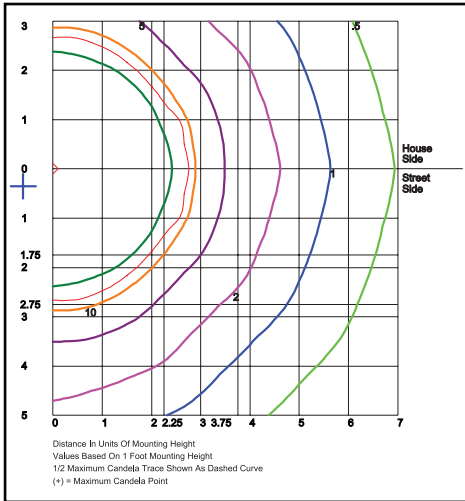

BOZB2C34X5U41K
Grid in feet, Mounting Height=1ft.

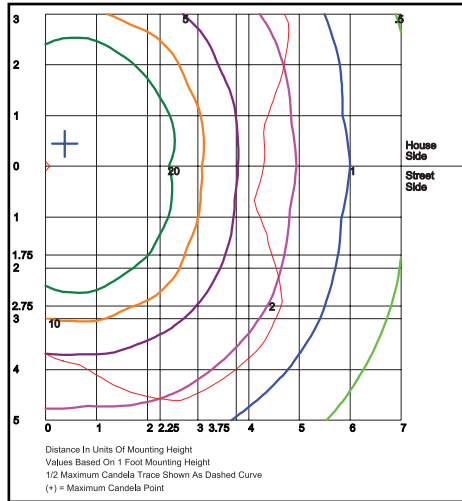

BOZB2C34X5U41K
Grid in feet, Mounting Height=1ft.

PHOTOMETRIC PERFORMANCE

LED COB Watts	Drive Current (mA)	Input Watts	Bollards	4100 CCT 80 CRI				
				Lumens	LPW	B	U	G
COB LED 20w	350	20	BOZB1C3 (Round Low Profile Pathway Bollards)	2,282	87	1	0	1
			BOZB2C3 (Square Low Profile Pathway Bollards)	2,409	91	1	0	1

PROJECTED LUMEN MAINTENANCE

Data shown for 4000 CCT		Compare to MH				
TM-21-11	Input Watts	Initial	25,000 Hrs	50,000 Hrs	100,000 Hrs	Calculated L70@ 25°C
BOZB1C3 L70 Lumen Maintenance @ 25°C / 77°F	20	1.00	0.93	0.86	0.72	106,000
BOZB2C3 L70 Lumen Maintenance @ 25°C / 77°F	20	1.00	0.93	0.86	0.72	106,000
TM-21-11	Input Watts	Initial	25,000 Hrs	50,000 Hrs	100,000 Hrs	Calculated L70@ 50°C
BOZB1C3 L70 Lumen Maintenance @ 50°C / 122°F	20	1.00	0.91	0.83	0.66	88,000
BOZB2C3 L70 Lumen Maintenance @ 50°C / 122°F	20	1.00	0.91	0.83	0.66	88,000
TM-21-11	Input Watts	Initial	25,000 Hrs	50,000 Hrs	100,000 Hrs	Calculated L80@ 40°C
BOZB1C3 L80 Lumen Maintenance @ 40°C / 104°F	20	1.00	0.92	0.84	0.67	61,000
BOZB2C3 L80 Lumen Maintenance @ 40°C / 104°F	20	1.00	0.92	0.84	0.67	61,000

NOTES:
 1. Projected per IESNA TM-21-11. Data references the extrapolated performance projections for the 116mA base model in a 25°C ambient, based on 10,000 hours of LED testing per IESNA LM-80-08.
 2. Compare to MH box indicates suggested Light Loss Factor (LLF) to be used when comparing to Metal Halide (MH) systems.