

Smart Sense H6L Series

H6L High Bay Workhorse



Integral Sensor Switch
Occupancy Sensor

DIMENSIONS

Top View

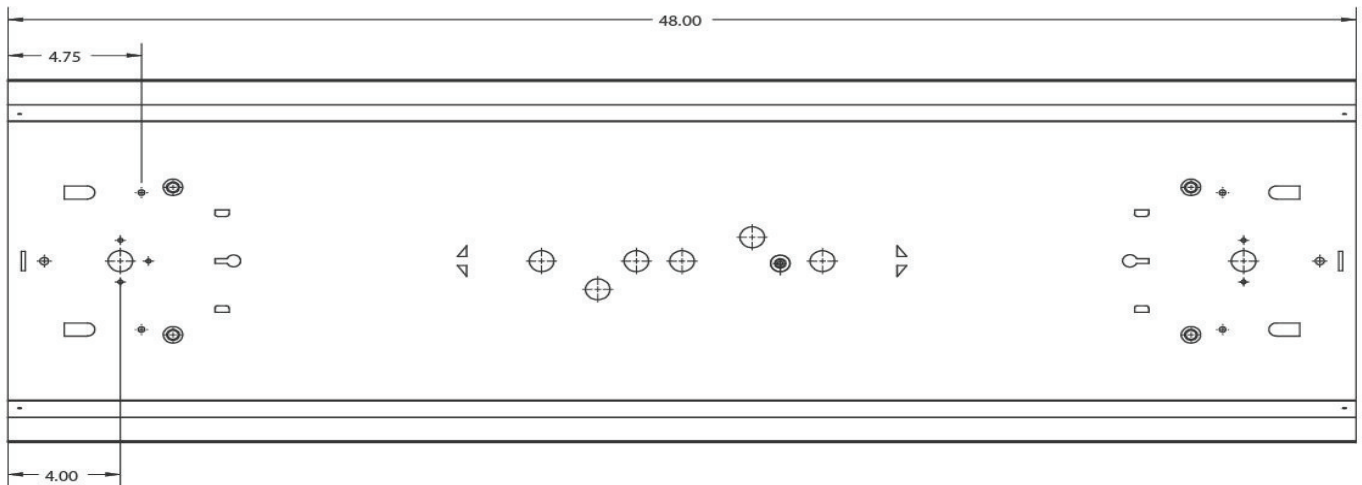



HIGH BAY 360° SENSOR SNAP FIT ENCLOSURE • LINE VOLTAGE • PASSIVE INFRARED

SPECIFICATIONS

FEATURES

- Self-Contained Relay,
No Power Pack Needed
- No Minimum Load Requirements
- Interchangeable Hot & Load Wires,
Impossible to Wire Backwards
- Push-Button Programmable
Adjustable Time Delays
- No Field Calibration or Sensitivity
Adjustments Required
- Convenient Test Mode
- 100 hr Lamp Burn-in Timer
- Green LED Indicator

LAMPMAXIMIZER® TECHNOLOGY

- Protects Lamp Life while
Maximizing Energy Savings
- Minimum On Timer (15 min default)
- Occ. Time Delay (10 min default)

PHYSICAL SPECS

- SIZE 2.25" H x 1.38" W x 0.82" D
(5.715 cm x 3.51 cm x 2.08 cm)
- WEIGHT 4 oz.
- MOUNTING Snaps into 2 3/16" H x
1 5/16" W x 1" D cavity in fixture
- COLOR White

ELECTRICAL SPECS

- LOAD RATING (1 PHASE ONLY)
 - 800 W @ 120 VAC
 - 1200 W @ 277 VAC
 - 1500 W @ 347 VAC
- MOTOR LOAD 1/4 HP
- FREQUENCY 50/60 Hz
- Timers are 1.2x for 50 Hz

ENVIRONMENTAL SPECS

- OPERATING TEMP
14° to 160° F (-10° to 71° C)
- STORAGE TEMP
-14° to 160° F (-26° to 71° C)
- RELATIVE HUMIDITY
20 to 90% non-condensing
- SILICONE FREE
- ROHS COMPLIANT

OVERVIEW

The Snap-Fit High Bay sensor is a compact line voltage sensor that snaps directly into a small cavity in a fixture. The sensor utilizes Passive Infrared (PIR) detection to detect motion from occupants within its 360° coverage pattern that overlaps that of most HID, T-5, or T-8 fixtures used in warehouse applications.

SENSOR OPERATION

The sensor detects changes in the infrared energy given off by occupants as they move within the field-of-view. When occupancy is detected, a self-contained relay switches the connected lighting load on. The sensor is line powered, switches line voltage, and requires no field calibration or sensitivity adjustments.

LAMPMAXIMIZER®

This sensor also contains patent pending LampMaximizer technology that allows users to aggressively target energy savings while still protecting lamp life. A minimum on timer, factory set at 15 minutes, helps preserve lamp life by eliminating all lamp cycles shorter than lamp manufacturers' recommendations.

A standard occupancy time delay is also present that ensures lights turn off (assuming minimum on timer has elapsed) if no occupancy is detected. This timer is factory set at 10 minutes to promote energy savings, but is adjustable between 30 seconds and 20 minutes. These adjustments can be done manually, through the unit's push-button; no tools required.

OPTIONS

347 VAC (347)

- Allows sensor to be powered from and switch 347 VAC

LOW TEMP/HIGH HUMIDITY (LT)

- Sensor is corrosion resistant to moisture
- Operates down to -40° F/C



TITLE 24
ASSEMBLED in U.S.A.
5 YEAR WARRANTY

ORDERING INFO SFR 5 [VOLTAGE] [TEMP/HUMIDITY]

VOLTAGE

Blank = 120/277 VAC
347 = 347 VAC

TEMP/HUMIDITY

Blank = Standard
LT = Low Temp

COVERAGE PATTERN

5 MINI HIGH BAY 360° LENS

- Recommended for fixtures that have a 1.0 spacing to mounting height ratio or less (e.g. fixtures 30' on center or less @ a 30' mounting height).
- Recommended for mounting heights between 30 to 45 ft (9.14 to 13.72 m) only
- 15 to 20 ft (4.57 to 7.62 m) radial coverage overlaps area lit by a typical high bay fixture
- Excellent detection of large motion (e.g. walking) up to a 35 ft (10.67 m) mounting height
- Excellent detection of extra large motion (e.g. forklifts) up to a 45 ft (13.72 m) mounting height

MASKING KIT

- A masking kit is provided in order to mask off a portion of the view pattern for end-of-aisle applications; or to trim the sensor's side viewing to create a rectangular pattern for center-of-aisle viewing only.

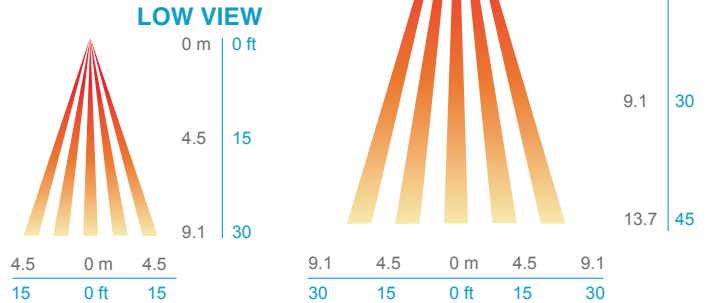
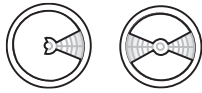

WIRING (DO NOT WIRE HOT)

STANDARD WIRING

- BLACK* - Line Input
 - BLACK* - Load Output
 - WHITE - Neutral
- *BLACK wires can be reversed

347 VAC OPTION

Black wires are replaced w/ Red wires

INITIAL POWER UP (3 MINUTE WARM-UP)

The relay in the sensor is shipped in a latched closed position so that when power is initially applied the lights will come on. The sensor will then begin to time out after a 1-3 minute warm-up period. If the lights do not immediately turn on (initial installation only) the latching relay opened during shipment and will close after warm-up period is over.

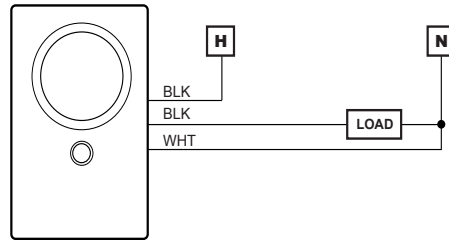

INSTALLATION

MOUNTING

- The snap fit enclosure is designed to fit snugly inside a 2 3/16" H x 1 5/16" W x 1" D cavity in a low bay lighting fixture.

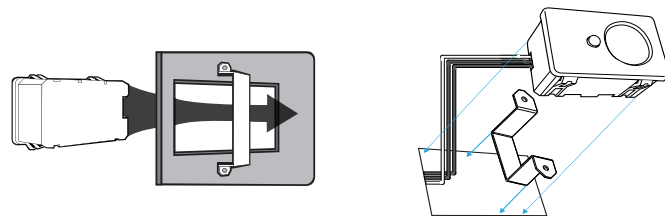
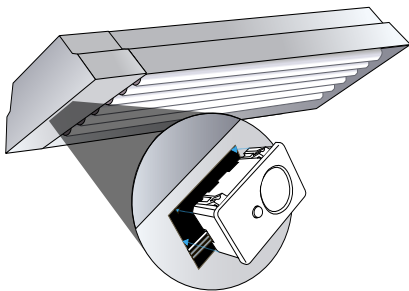

Diagrams show internal cross section of fixture with bracket included for additional sensor impact strength.

- For optimal detection, position sensor such that segments are crossed upon entrance and unable to view outside the space

PROGRAMMING

Refer to instruction card IC1-002 for default settings and directions on programming the sensor via the push-button.

sensorswitch

An AcuityBrands Company

WARRANTY: Sensor Switch, Inc. warrants these products to be free of defects in manufacture and workmanship for a period of 60 months. Sensor Switch, Inc., upon prompt notice of such defect, will, at its option, provide a Returned Material Authorization number and repair or replace returned product.

LIMITATIONS AND EXCLUSIONS: This Warranty is in full lieu of all other representation and expressed and implied warranties (including the implied warranties of merchantability and fitness for use) and under no circumstances shall Sensor Switch, Inc. be liable for any incidental or consequential property damages or losses.

TS-SFR-001A